

Pavement
Treatment Plans





BUSCONNECTS DUBLIN CORE BUS CORRIDORS INFRASTRUCTURE WORKS

RINGSEND TO CITY CENTRE CORE BUS CORRIDOR SCHEME

| PROPOSED PAVEMENT CONSTRUCTION | |
|--|---|
| DRAWING SERIES NUMBER(S) | DRAWING SERIES DESCRIPTION |
| BCIDD-ROT-PAV_IX-0016_XX_00-DR-CR-001 | RINGSEND TO CITY CENTRE CORE BUS CORRIDOR SCHEME. PAVEMENT TREATMENT PLANS. COVER SHEET |
| BCIDD-ROT-PAV_KP-0016_XX_00-DR-CR-0001 | RINGSEND TO CITY CENTRE CORE BUS CORRIDOR SCHEME. PAVEMENT TREATMENT PLANS. KEY PLAN |
| BCIDD-ROT-PAV_PV-0016_XX_00-DR-CR-0001 to 0012 | RINGSEND TO CITY CENTRE CORE BUS CORRIDOR SCHEME. PAVEMENT TREATMENT PLANS. DRAWINGS. |

Disclaimer
 a. © National Transport Authority (NTA) 2022. This drawing is confidential and the copyright in it is owned by NTA. This drawing must not be either loaned, copied or otherwise reproduced in whole or in part or used for any purpose without the prior permission of NTA.
 b. This drawing is to be used for the design element identified in the title block. Other information shown is to be considered indicative only. The drawing is to be read in conjunction with all other relevant design drawings.
 c. O.S. data used for plans are printed under © Ordnance Survey Ireland Government of Ireland. All rights reserved. Licence Number 2022/OSI_NMA_180 National Transport Authority. All elevations are in metres and relate to OSI Geoid Model (OSGM15) Mean Head. All Co-ordinates are in Irish

Transverse Mercator Grid (ITM) as defined by OSI active local GPS station.
 d. Information concerning the position of apparatus shown on this drawing is based on drawings supplied by the utility owners and/or the utility works contractor, whilst every care has been taken in the preparation of this drawing, positions should be taken as approximate and are intended for general guidance only and no representation is made by the NTA as to the accuracy, completeness, sufficiency or otherwise of this drawing and the position of the apparatus. The information contained herein does not purport to be comprehensive or final as the apparatus is subject to being altered and/or superceded. Recipients should not rely on this information. Any liabilities are hereby expressly disclaimed.

e. The information contained herein has been provided by the NTA but does not purport to be comprehensive or final. Recipients should not rely on the information. Neither the NTA nor any of its directors, officers, employees, agents, stakeholders or advisers make any representation or warranty as to, or accept any liability or responsibility in relation to, the adequacy, accuracy, reasonableness or completeness of the information provided as part of this document or any matter on which the information is based (including but not limited to loss or damage arising as a result of reliance by recipients on the information or any part of it). Any liabilities are hereby expressly disclaimed.



| Rev | Date | Drn | Chk'd | App'd | Description |
|-----|----------|-----|-------|-------|-----------------------------|
| M01 | MAR 2023 | SCH | EFD | SMG | ISSUE FOR PHASE 4: PLANNING |

| | | | | |
|--|---------------------------------------|---|----------------|-----------------|
| Client NTA Údarás Náisiúnta Iompair National Transport Authority | | Engineering Designer ROD ROUGHAN & O'DONOVAN TYPASA | | |
| Date MAR 2023 | Scale 1:10000 @ A1 1:20000 @ A3 | Drawn SCH | Checked EFD | Approved SMG |
| Project Code BCIDD | Originator Code ROT | QMS Code | | |

| | | | |
|---|--------------------------|-------------|------------|
| Programme Title BUSCONNECTS DUBLIN CORE BUS CORRIDORS INFRASTRUCTURE WORKS | | | |
| Drawing Title RINGSEND TO CITY CENTRE CORE BUS CORRIDOR SCHEME PAVEMENT TREATMENT PLANS. COVERSHEET | | | |
| Drawing File Name BCIDD-ROT-PAV_IX-0016_XX_00-DR-CR-0001 | Sheet Number 01 of 01 | Status A | Rev M01 |

DO NOT SCALE USE FIGURED DIMENSIONS ONLY

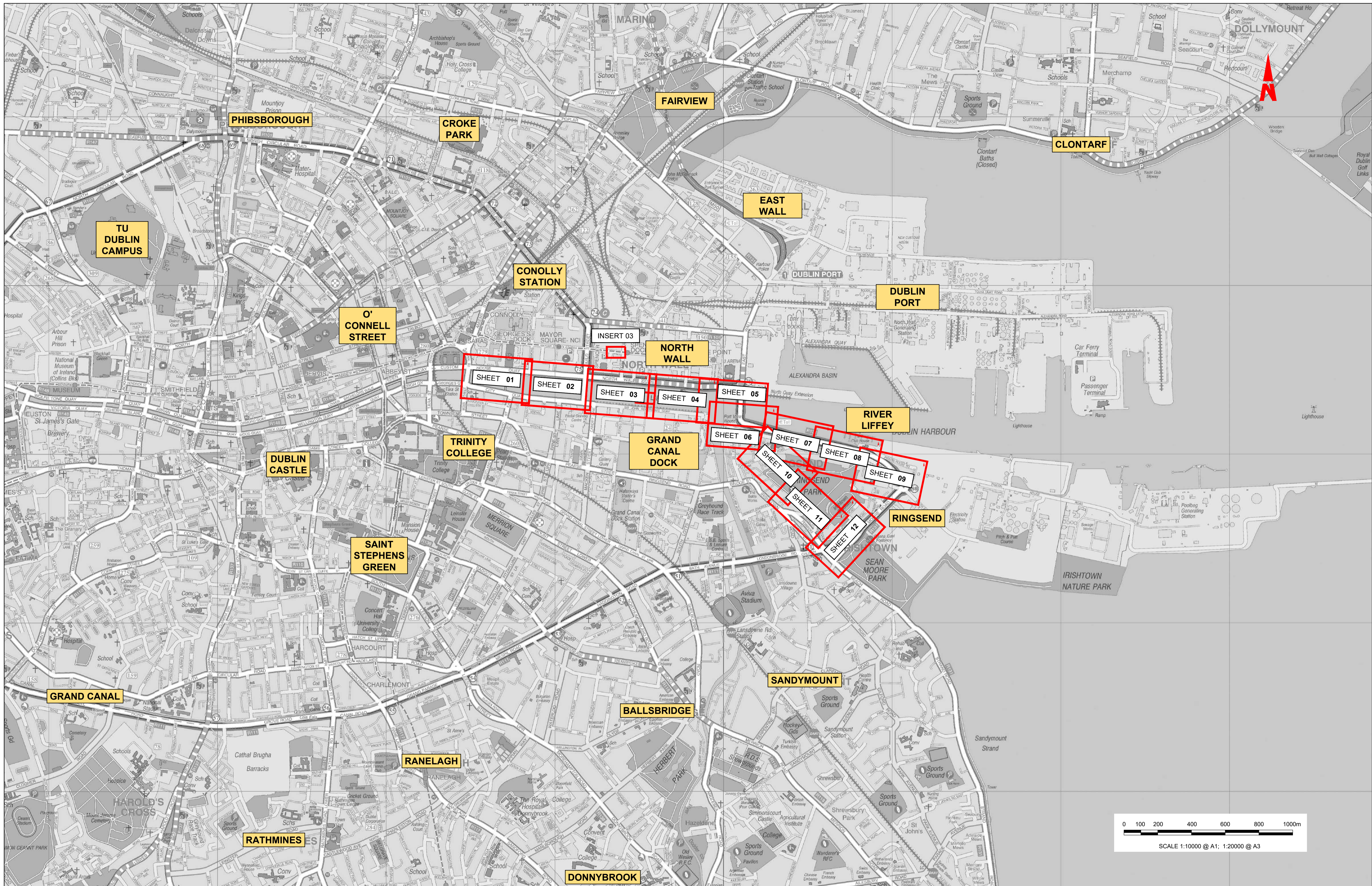

Disclaimer
 a. © National Transport Authority (NTA) 2022. This drawing is confidential and the copyright in it is owned by NTA. This drawing must not be either loaned, copied or otherwise reproduced in whole or in part or used for any purpose without the prior permission of NTA.
 b. This drawing is to be used for the design element identified in the title block. Other information shown is to be considered indicative only. The drawing is to be read in conjunction with all other relevant design drawings.
 c. O.S. data used for plans are printed under © Ordnance Survey Ireland Government of Ireland. All rights reserved. Licence Number 2022/OSI_NMA_180 National Transport Authority. All elevations are in metres and relate to OSi Geoid Model (OSGM15) Mean Head. All Co-ordinates are in Irish Transverse Mercator Grid (ITM) as defined by OSI active local GPS station.
 d. Information concerning the position of apparatus shown on this drawing is based on drawings supplied by the utility owners and/or the utility works contractor, whilst every care has been taken in the preparation of this drawing, positions should be taken as approximate and are intended for general guidance only and no representation is made by the NTA as to the accuracy, completeness, sufficiency or otherwise of this drawing and the position of the apparatus. The information contained herein does not purport to be comprehensive or final as the apparatus is subject to being altered and/or superceded. Recipients should not rely on this information. Any liabilities are hereby expressly disclaimed.

The information contained herein has been provided by the NTA but does not purport to be comprehensive or final. Recipients should not rely on the information. Neither the NTA nor any of its directors, officers, employees, agents, stakeholders or advisers make any representation or warranty as to, or accept any liability or responsibility in relation to, the adequacy, accuracy, reasonableness or completeness of the information provided as part of this document or any matter on which the information is based (including but not limited to loss or damage arising as a result of reliance by recipients on the information or any part of it). Any liabilities are hereby expressly disclaimed.

Rev | Date | Dm | Chk'd | App'd | Description
 M01 | MAR 2023 | SCH | EFD | SMG | ISSUE FOR PHASE 4: PLANNING

NTA
 Údarás Náisiúnta Iompair
 National Transport Authority

Date: MAR 2023 | Scale: 1:10000 @ A1, 1:20000 @ A3
 Project Code: BCIDD | Originator Code: ROT

Engineering Designer: **PROD** TYPSA

Client: **NTA**

Drawn: SCH | Checked: EFD | Approved: SMG

QMS Code

Programme Title: **BUSCONNECTS DUBLIN CORE BUS CORRIDORS INFRASTRUCTURE WORKS**

Drawing Title: RINGSEND TO CITY CENTRE CORE BUS CORRIDOR SCHEME PAVEMENT TREATMENT PLANS KEY PLAN

Drawing File Name: BCIDD-ROT-PAV_KP-0016_XX_00-DR-CR-0001 | Sheet Number: 01 of 01 | Status: A | Rev: M01

DO NOT SCALE USE FIGURED DIMENSIONS ONLY

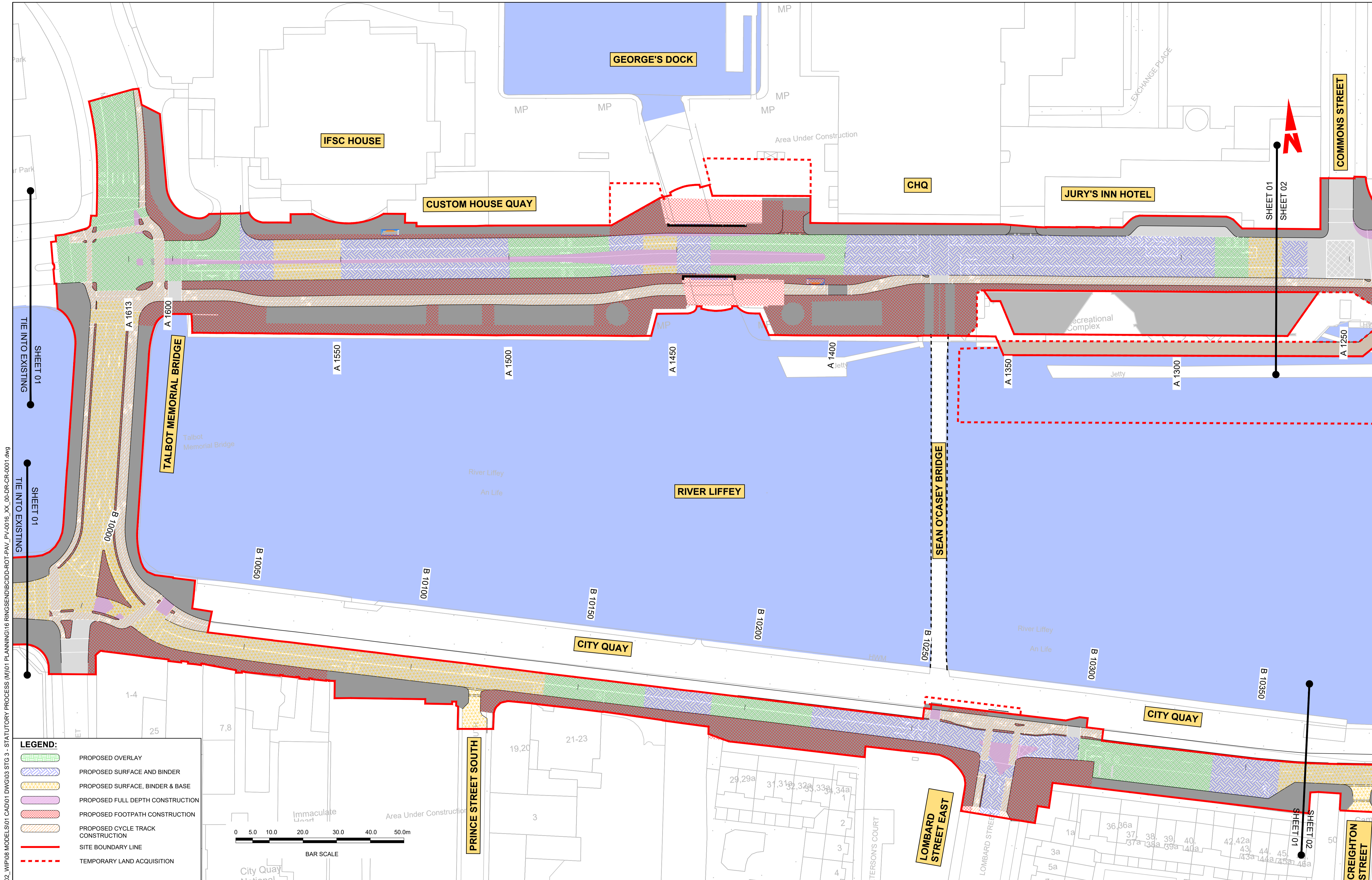

LEGEND:

- PROPOSED OVERLAY
- PROPOSED SURFACE AND BINDER
- PROPOSED SURFACE, BINDER & BASE
- PROPOSED FULL DEPTH CONSTRUCTION
- PROPOSED FOOTPATH CONSTRUCTION
- PROPOSED CYCLE TRACK CONSTRUCTION
- SITE BOUNDARY LINE
- TEMPORARY LAND ACQUISITION

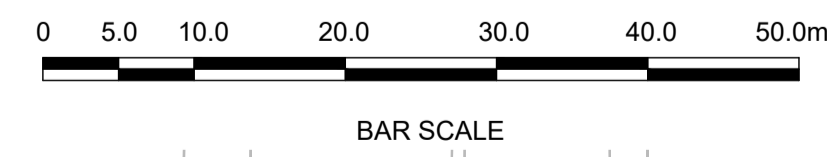

Disclaimer
 a. © National Transport Authority (NTA) 2022. This drawing is confidential and the copyright in it is owned by NTA. This drawing must not be either loaned, copied or otherwise reproduced in whole or in part or used for any purpose without the prior permission of NTA.
 b. This drawing is to be used for the design element identified in the titleblock. Other information shown is to be considered indicative only. The drawing is to be read in conjunction with all other relevant design drawings.
 c. O.S. data used for plans are printed under © Ordnance Survey Ireland Government of Ireland. All rights reserved. Licence Number 2022/OSI_NMA_180 National Transport Authority. All elevations are in metres and relate to OSI Geoid Model (OSGM15) Mean Head. All Co-ordinates are in Irish Transverse Mercator Grid (ITM) as defined by OSI active local GPS station.
 d. Information concerning the position of apparatus shown on this drawing is based on drawings supplied by the utility owners and/or the utility works contractor, whilst every care has been taken in the preparation of this drawing, positions should be taken as approximate and are intended for general guidance only and no representation is made by the NTA as to the accuracy, completeness, sufficiency or otherwise of this drawing and the position of the apparatus. The information contained herein does not purport to be comprehensive or final as the apparatus is subject to being altered and/or superceded. Recipients should not rely on this information. Any liabilities are hereby expressly disclaimed.
 e. The information contained herein has been provided by the NTA but does not purport to be comprehensive or final. Recipients should not rely on the information. Neither the NTA nor any of its directors, officers, employees, agents, stakeholders or advisers make any representation or warranty as to, or accept any liability or responsibility in relation to, the adequacy, accuracy, reasonableness or completeness of the information provided as part of this document or any matter on which the information is based (including but not limited to loss or damage arising as a result of reliance by recipients on the information or any part of it). Any liabilities are hereby expressly disclaimed.



| Rev | Date | Drn | Chk'd | App'd | Description |
|-----|----------|-----|-------|-------|-----------------------------|
| M01 | MAR 2023 | SCH | EFD | SMG | ISSUE FOR PHASE 4: PLANNING |

Client: **NTA**
 Údarás Náisiúnta Iompair
 National Transport Authority

Engineering Designer: **CIROD**
 TYPSA

Date: MAR 2023
 Scale: 1:500 @ A1
 1:1,000 @ A3

Drawn: SCH
 Checked: EFD
 Approved: SMG

Programme Code: BCIDD
 Originator Code: ROT
 QMS Code:

Programme Title: **BUSCONNECTS DUBLIN**
CORE BUS CORRIDORS INFRASTRUCTURE WORKS

Drawing Title: RINGSEND TO CITY CENTRE CORE BUS CORRIDOR SCHEME
 PAVEMENT TREATMENT PLANS

Drawing File Name: BCIDD-ROT-PAV_PV-0016_XX_00-DR-CR-0001
 Sheet Number: 01 of 12
 Status: A
 Rev: M01

DO NOT SCALE USE FIGURED DIMENSIONS ONLY

\\wddubp1u2019191717117-02_WIP08 MODELS01 CAD01 DWG003 STG 3 - STATUTORY PROCESS (M)01 PLANNING\16 RINGSEND\BCIDD-ROT-PAV_PV-0016_XX_00-DR-CR-0001.dwg

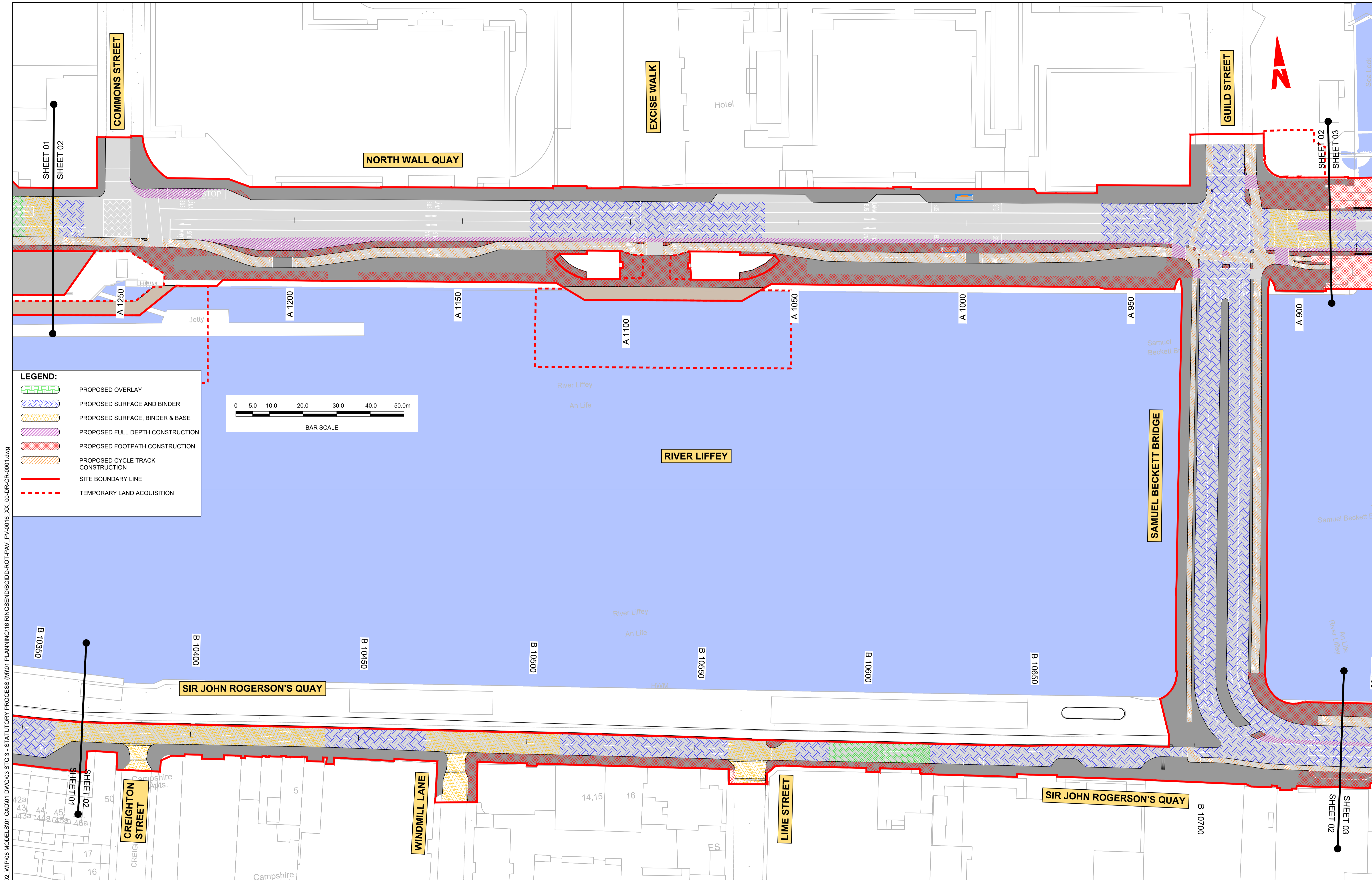

W:\000000\1917117-02_WIP\08 MODELS\01 CAD\01 DWG\03 STG 3 - STATUTORY PROCESS (M)\01 PLANNING\16 RINGSEND\BCIDD-ROT-PAV_PV-0016_XX_00-DR-CR-0001.dwg

LEGEND:

- PROPOSED OVERLAY
- PROPOSED SURFACE AND BINDER
- PROPOSED SURFACE, BINDER & BASE
- PROPOSED FULL DEPTH CONSTRUCTION
- PROPOSED FOOTPATH CONSTRUCTION
- PROPOSED CYCLE TRACK CONSTRUCTION
- SITE BOUNDARY LINE
- TEMPORARY LAND ACQUISITION



| <p><small>Disclaimer</small></p> <p>a. © National Transport Authority (NTA) 2022. This drawing is confidential and the copyright in it is owned by NTA. This drawing must not be either loaned, copied or otherwise reproduced in whole or in part or used for any purpose without the prior permission of NTA.</p> <p>b. This drawing is to be used for the design element identified in the titleblock. Other information shown is to be considered indicative only. The drawing is to be read in conjunction with all other relevant design drawings.</p> <p>c. O.S. data used for plans are printed under © Ordnance Survey Ireland Government of Ireland. All rights reserved. Licence Number 2022/OSI_NMA_180 National Transport Authority. All elevations are in metres and relate to OSI Geoid Model (OSGM15) Mean Head. All Co-ordinates are in Irish Transverse Mercator Grid (ITM) as defined by OSI active local GPS station.</p> <p>d. Information concerning the position of apparatus shown on this drawing is based on drawings supplied by the utility owners and/or the utility works contractor, whilst every care has been taken in the preparation of this drawing, positions should be taken as approximate and are intended for general guidance only and no representation is made by the NTA as to the accuracy, completeness, sufficiency or otherwise of this drawing and the position of the apparatus. The information contained herein does not purport to be comprehensive or final as the apparatus is subject to being altered and/or superceded. Recipients should not rely on this information. Any liabilities are hereby expressly disclaimed.</p> <p>e. The information contained herein has been provided by the NTA but does not purport to be comprehensive or final. Recipients should not rely on the information. Neither the NTA nor any of its directors, officers, employees, agents, stakeholders or advisers make any representation or warranty as to, or accept any liability or responsibility in relation to, the adequacy, accuracy, reasonableness or completeness of the information provided as part of this document or any matter on which the information is based (including but not limited to loss or damage arising as a result of reliance by recipients on the information or any part of it). Any liabilities are hereby expressly disclaimed.</p> | <p>Project Ireland 2040 Building Ireland's Future</p> | <table border="1" style="width: 100%; border-collapse: collapse;"> <thead> <tr> <th>Rev</th> <th>Date</th> <th>Drn</th> <th>Chk'd</th> <th>App'd</th> <th>Description</th> </tr> </thead> <tbody> <tr> <td>M01</td> <td>MAR 2023</td> <td>SCH</td> <td>EFD</td> <td>SMG</td> <td>ISSUE FOR PHASE 4: PLANNING</td> </tr> </tbody> </table> | Rev | Date | Drn | Chk'd | App'd | Description | M01 | MAR 2023 | SCH | EFD | SMG | ISSUE FOR PHASE 4: PLANNING | <p>Client</p> <p>NTA Údarás Náisiúnta Iompair National Transport Authority</p> | <p>Engineering Designer</p> <p>IROD TYPSA</p> | <p>Programme Title</p> <p>BUSCONNECTS DUBLIN CORE BUS CORRIDORS INFRASTRUCTURE WORKS</p> <p>Drawing Title</p> <p>RINGSEND TO CITY CENTRE CORE BUS CORRIDOR SCHEME PAVEMENT TREATMENT PLANS</p> |
|---|--|---|-------|-------------------------|-----------------------------|--|-------|-------------------------------------|-----|----------|-----|-----|-----|-----------------------------|---|--|---|
| Rev | Date | Drn | Chk'd | App'd | Description | | | | | | | | | | | | |
| M01 | MAR 2023 | SCH | EFD | SMG | ISSUE FOR PHASE 4: PLANNING | | | | | | | | | | | | |
| <p>Date</p> <p>MAR 2023</p> | | <p>Scale</p> <p>1:500 @ A1 1:1,000 @ A3</p> | | <p>Drawn</p> <p>SCH</p> | | <p>Checked</p> <p>EFD</p> | | <p>Approved</p> <p>SMG</p> | | | | | | | | | |
| <p>Programme Code</p> <p>BCIDD</p> | | <p>Originator Code</p> <p>ROT</p> | | <p>QMS Code</p> | | <p>Drawing File Name</p> <p>BCIDD-ROT-PAV_PV-0016_XX_00-DR-CR-0002</p> | | <p>Sheet Number</p> <p>02 of 12</p> | | | | | | | | | |
| | | | | | | <p>Status</p> <p>A</p> | | <p>Rev</p> <p>M01</p> | | | | | | | | | |

DO NOT SCALE USE FIGURED DIMENSIONS ONLY

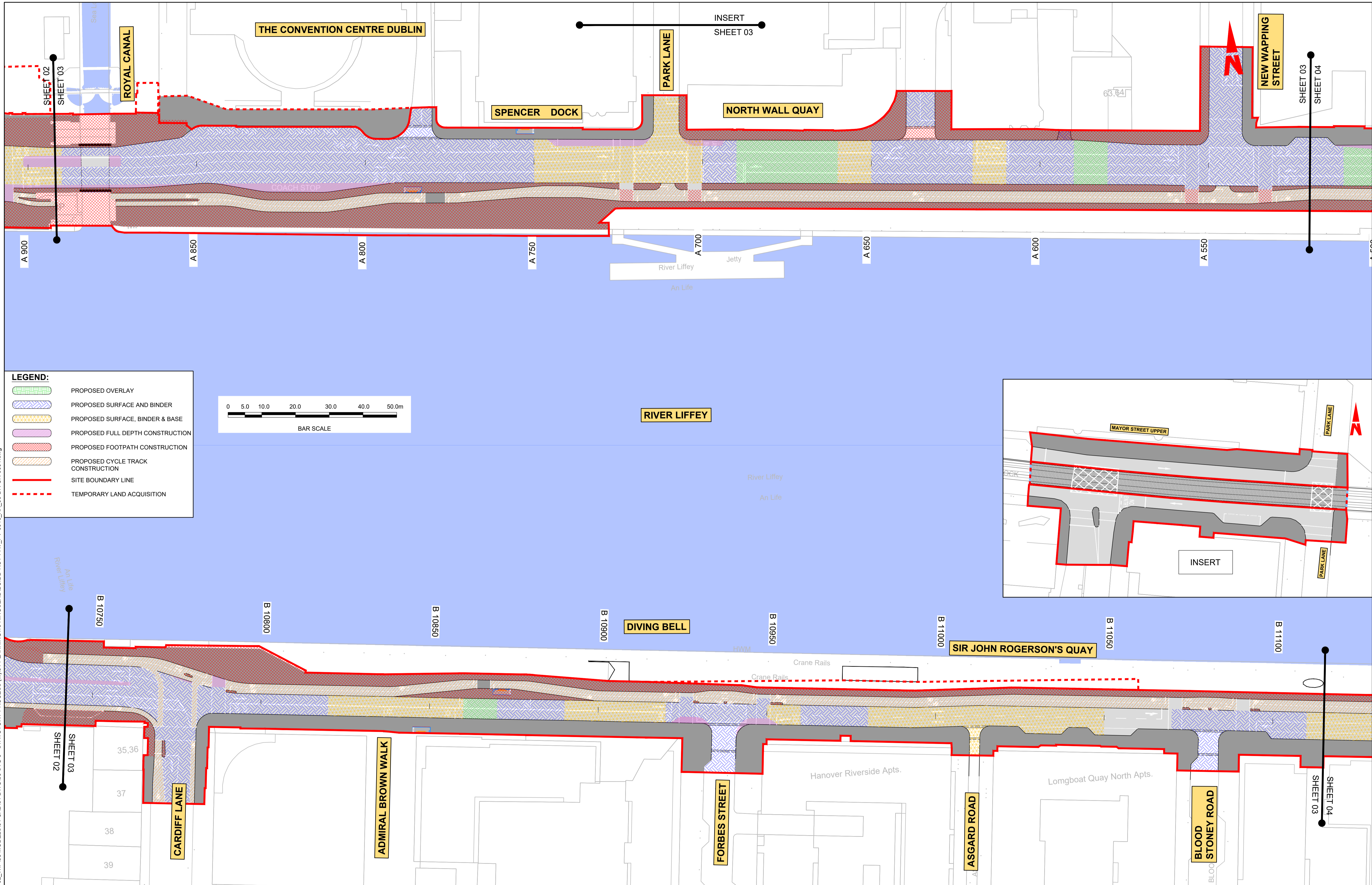

Disclaimer
 a. © National Transport Authority (NTA) 2022. This drawing is confidential and the copyright in it is owned by NTA. This drawing must not be either loaned, copied or otherwise reproduced in whole or in part or used for any purpose without the prior permission of NTA.
 b. This drawing is to be used for the design element identified in the titlebox. Other information shown is to be considered indicative only. The drawing is to be read in conjunction with all other relevant design drawings.
 c. O.S. data used for plans are printed under © Ordnance Survey Ireland Government of Ireland. All rights reserved. Licence Number 2022/OSI_NMA_180 National Transport Authority. All elevations are in metres and relate to OSI Geoid Model (OSGM15) Mean Head. All Co-ordinates are in Irish Transverse Mercator Grid (ITM) as defined by OSI active local GPS station.
 d. Information concerning the position of apparatus shown on this drawing is based on drawings supplied by the utility owners and/or the utility works contractor, whilst every care has been taken in the preparation of this drawing, positions should be taken as approximate and are intended for general guidance only and no representation is made by the NTA as to the accuracy, completeness, sufficiency or otherwise of this information and the position of the apparatus. The information contained herein does not purport to be comprehensive or final as the apparatus is subject to being altered and/or superseded. Recipients should not rely on this information. Any liabilities are hereby expressly disclaimed.
 e. The information contained herein has been provided by the NTA but does not purport to be comprehensive or final. Recipients should not rely on the information. Neither the NTA nor any of its directors, officers, employees, agents, stakeholders or advisers make any representation or warranty as to, or accept any liability or responsibility in relation to, the adequacy, accuracy, reasonableness or completeness of the information provided as part of this document or any matter on which the information is based (including but not limited to loss or damage arising as a result of reliance by recipients on the information or any part of it). Any liabilities are hereby expressly disclaimed.

Project Ireland 2040
 Building Ireland's Future

| Rev | Date | Drn | Chk'd | App'd | Description |
|-----|----------|-----|-------|-------|-----------------------------|
| M01 | MAR 2023 | SCH | EFD | SMG | ISSUE FOR PHASE 4: PLANNING |

NTA
 Údarás Náisiúnta Iompair
 National Transport Authority

Engineering Designer
CIROD
 TYPSA

| | | | | |
|----------|----------------------------|-------|---------|----------|
| Date | Scale | Drawn | Checked | Approved |
| MAR 2023 | 1:500 @ A1 1:1,000 @ A3 | SCH | EFD | SMG |

Programme Code: BCIDD
 Originator Code: ROT
 QMS Code:

| | | | |
|--|---------------------------------|--------------------|-------------------|
| Programme Title BUSCONNECTS DUBLIN CORE BUS CORRIDORS INFRASTRUCTURE WORKS | | | |
| Drawing Title RINGSEND TO CITY CENTRE CORE BUS CORRIDOR SCHEME PAVEMENT TREATMENT PLANS | | | |
| Drawing File Name BCIDD-ROT-PAV_PV-0016_XX_00-DR-CR-0003 | Sheet Number 03 of 12 | Status A | Rev M01 |

DO NOT SCALE USE FIGURED DIMENSIONS ONLY

\\nodubp1\j\2019\19117-02_WIP\08 MODELS\01 CAD\01 PLANNING\16 RINGSEND\BCIDD-ROT-PAV_PV-0016_XX_00-DR-CR-0001.dwg

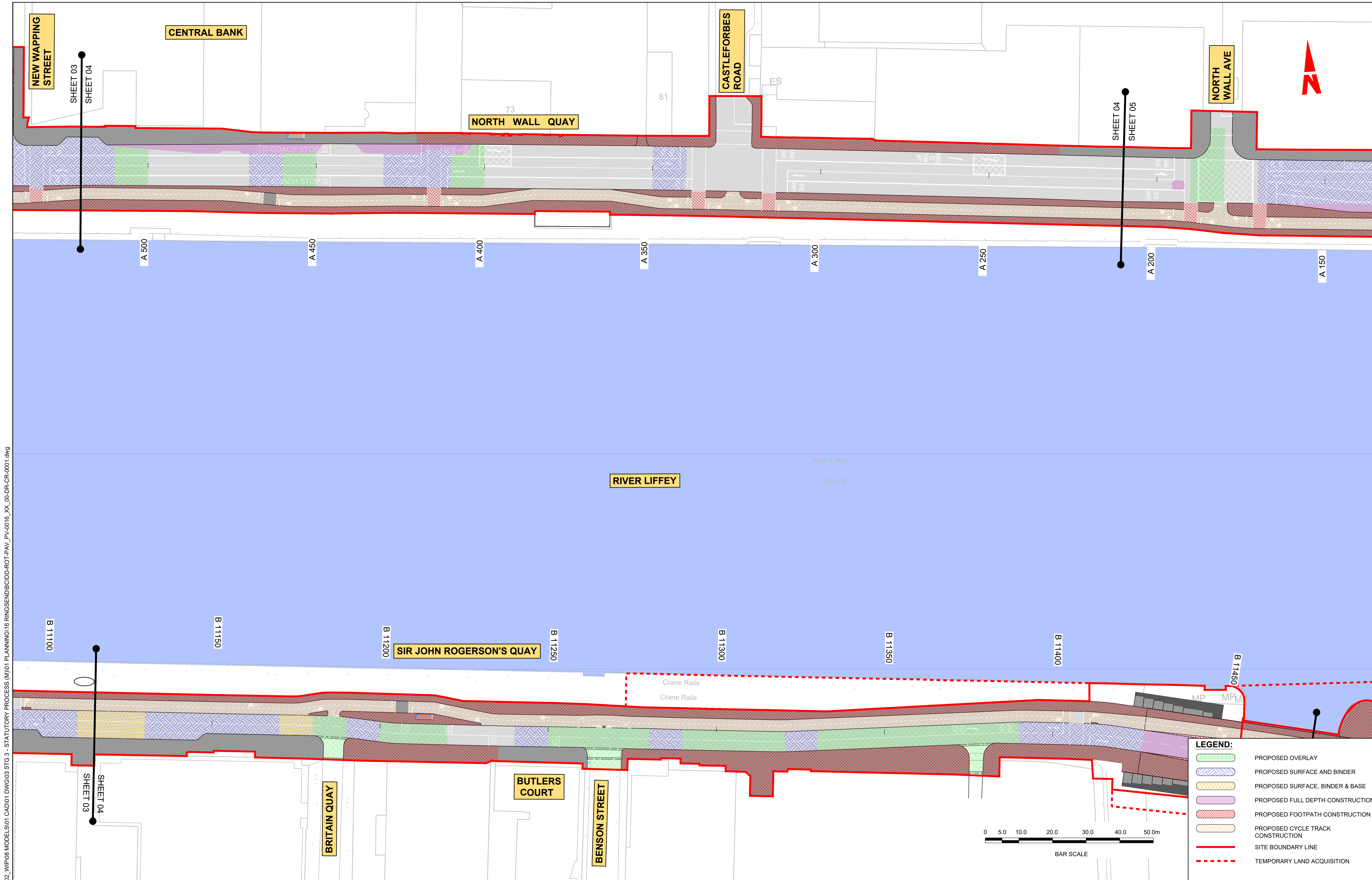

\\vodubp1\j\2019\1917\1917-02_WIP\08 MODELS\01 CAD\01 DWG\03 STG 3 - STATUTORY PROCESS (M)\01 PLANNING\16 RINGSEND\BCIDD-ROT-PAV_PV-0016_XX_00-DR-CR-0001.dwg

Disclaimer

a. © National Transport Authority (NTA) 2022. This drawing is confidential and the copyright in it is owned by NTA. This drawing must not be either loaned, copied or otherwise reproduced in whole or in part or used for any purpose without the prior permission of NTA.

b. This drawing is to be used for the design element identified in the titlebox. Other information shown is to be considered indicative only. The drawing is to be read in conjunction with all other relevant design drawings.

c. O.S. data used for plans are printed under © Ordnance Survey Ireland Government of Ireland. All rights reserved. Licence Number 2022/OSI_NMA_180 National Transport Authority. All elevations are in metres and relate to OSI Geoid Model (OSGM15) Mean Head. All Co-ordinates are in Irish Transverse Mercator Grid (ITM) as defined by OSI active local GPS station.

d. Information concerning the position of apparatus shown on this drawing is based on drawings supplied by the utility owners and/or the utility works contractor, whilst every care has been taken in the preparation of this drawing, positions should be taken as approximate and are intended for general guidance only and no representation is made by the NTA as to the accuracy, completeness, sufficiency or otherwise of this drawing and the position of the apparatus. The information contained herein does not purport to be comprehensive or final as the apparatus is subject to being altered and/or superceded. Recipients should not rely on this information. Any liabilities are hereby expressly disclaimed.

e. The information contained herein has been provided by the NTA but does not purport to be comprehensive or final. Recipients should not rely on the information. Neither the NTA nor any of its directors, officers, employees, agents, stakeholders or advisers make any representation or warranty as to, or accept any liability or responsibility in relation to, the adequacy, accuracy, reasonableness or completeness of the information provided as part of this document or any matter on which the information is based (including but not limited to loss or damage arising as a result of reliance by recipients on the information or any part of it). Any liabilities are hereby expressly disclaimed.

| Rev | Date | Drn | Chk'd | App'd | Description |
|-----|----------|-----|-------|-------|-----------------------------|
| M01 | MAR 2023 | SCH | EFD | SMG | ISSUE FOR PHASE 4: PLANNING |

Client: **NTA**
Údarás Náisiúnta Iompair
National Transport Authority

Engineering Designer: **CIROD**
TYPSA

Date: MAR 2023 | Scale: 1:500 @ A1, 1:1,000 @ A3 | Drawn: SCH | Checked: EFD | Approved: SMG

Programme Code: BCIDD | Originator Code: ROT | QMS Code:

Programme Title: **BUSCONNECTS DUBLIN CORE BUS CORRIDORS INFRASTRUCTURE WORKS**

Drawing Title: RINGSEND TO CITY CENTRE CORE BUS CORRIDOR SCHEME PAVEMENT TREATMENT PLANS

Drawing File Name: BCIDD-ROT-PAV_PV-0016_XX_00-DR-CR-0004 | Sheet Number: 04 of 12 | Status: A | Rev: M01

DO NOT SCALE USE FIGURED DIMENSIONS ONLY

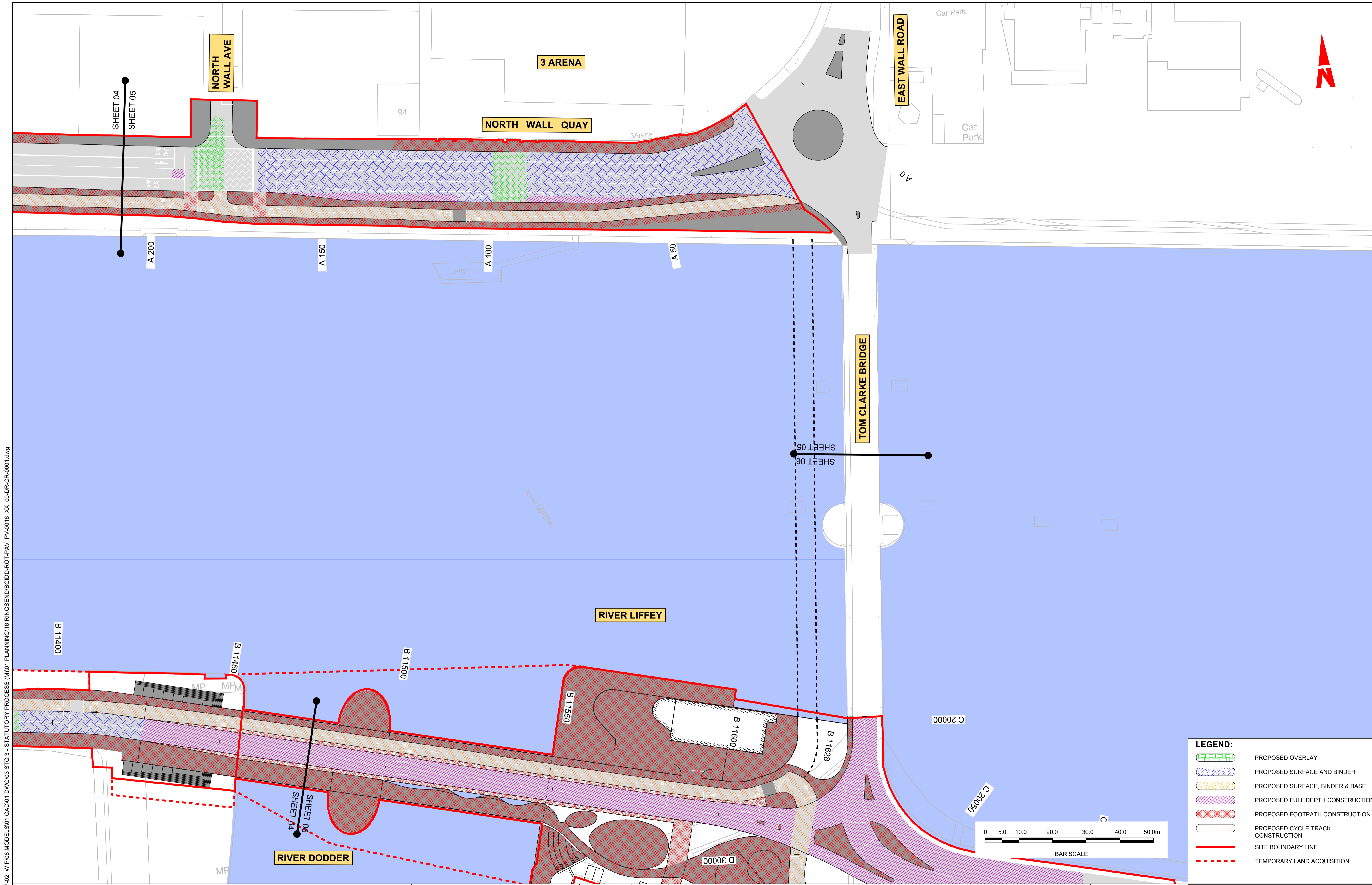

\\nodubp1\j\2019\1917\1917-02 - STATUTORY PROCESS (M)\01 PLANNING\16 RINGSEND\BCIDD-ROT-PAV_PV-0016_XX_00-DR-CR-0001.dwg

Disclaimer
 a. © National Transport Authority (NTA) 2022. This drawing is confidential and the copyright in it is owned by NTA. This drawing must not be either loaned, copied or otherwise reproduced in whole or in part or used for any purpose without the prior permission of NTA.
 b. This drawing is to be used for the design element identified in the titleblock. Other information shown is to be considered indicative only. The drawing is to be read in conjunction with all other relevant design drawings.
 c. O.S. data used for plans are printed under © Ordnance Survey Ireland Government of Ireland. All rights reserved. Licence Number 2022/OSI_NMA_180 National Transport Authority. All elevations are in metres and relate to OSI Geoid Model (OSGM15) Mean Head. All Co-ordinates are in Irish

Transverse Mercator Grid (ITM) as defined by OSI active local GPS station.
 d. Information concerning the position of apparatus shown on this drawing is based on drawings supplied by the utility owners and/or the utility works contractor, whilst every care has been taken in the preparation of this drawing, positions should be taken as approximate and are intended for general guidance only and no representation is made by the NTA as to the accuracy, completeness, sufficiency or otherwise of this drawing and the position of the apparatus. The information contained herein does not purport to be comprehensive or final as the apparatus is subject to being altered and/or superceded. Recipients should not rely on this information. Any liabilities are hereby expressly disclaimed.

e. The information contained herein has been provided by the NTA but does not purport to be comprehensive or final. Recipients should not rely on the information. Neither the NTA nor any of its directors, officers, employees, agents, stakeholders or advisers make any representation or warranty as to, or accept any liability or responsibility in relation to, the adequacy, accuracy, reasonableness or completeness of the information provided as part of this document or any matter on which the information is based (including but not limited to loss or damage arising as a result of reliance by recipients on the information or any part of it). Any liabilities are hereby expressly disclaimed.

| Rev | Date | Drm | Chk'd | App'd | Description |
|-----|----------|-----|-------|-------|-----------------------------|
| M01 | MAR 2023 | SCH | EFD | SMG | ISSUE FOR PHASE 4: PLANNING |

Client
NTA
 Údarás Náisiúnta Iompair
 National Transport Authority

| Engineering Designer | | |
|----------------------|----------------------------|----------|
| Date | Scale | Drawn |
| MAR 2023 | 1:500 @ A1 1:1,000 @ A3 | SCH |
| Programme Code | Originator Code | Checked |
| BCIDD | ROT | EFD |
| | | Approved |
| | | SMG |

| Programme Title | | | |
|--|--|--------------|--------|
| BUSCONNECTS DUBLIN | | | |
| CORE BUS CORRIDORS INFRASTRUCTURE WORKS | | | |
| Drawing Title | | | |
| RINGSEND TO CITY CENTRE CORE BUS CORRIDOR SCHEME PAVEMENT TREATMENT PLANS | | | |
| Drawing File Name | | Sheet Number | Status |
| BCIDD-ROT-PAV_PV-0016_XX_00-DR-CR-0005 | | 05 of 12 | A |
| Rev | | | M01 |

DO NOT SCALE USE FIGURED DIMENSIONS ONLY

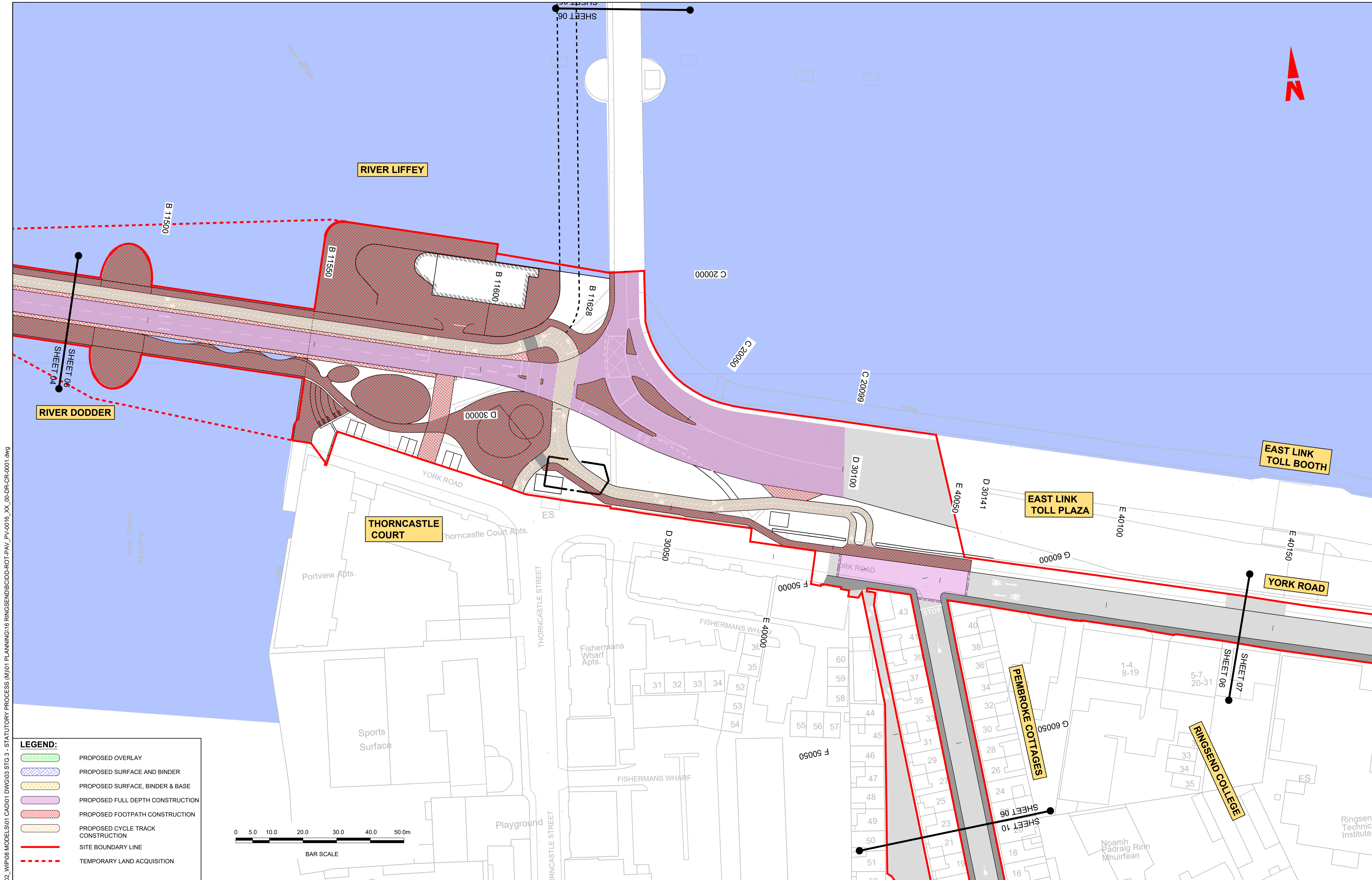

LEGEND:

| | |
|--|-----------------------------------|
| | PROPOSED OVERLAY |
| | PROPOSED SURFACE AND BINDER |
| | PROPOSED SURFACE, BINDER & BASE |
| | PROPOSED FULL DEPTH CONSTRUCTION |
| | PROPOSED FOOTPATH CONSTRUCTION |
| | PROPOSED CYCLE TRACK CONSTRUCTION |
| | SITE BOUNDARY LINE |
| | TEMPORARY LAND ACQUISITION |

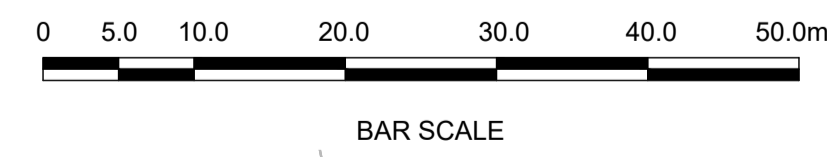

Disclaimer

a. © National Transport Authority (NTA) 2022. This drawing is confidential and the copyright in it is owned by NTA. This drawing must not be either loaned, copied or otherwise reproduced in whole or in part or used for any purpose without the prior permission of NTA.

b. This drawing is to be used for the design element identified in the titleblock. Other information shown is to be considered indicative only. The drawing is to be read in conjunction with all other relevant design drawings.

c. O.S. data used for plans are printed under © Ordnance Survey Ireland Government of Ireland. All rights reserved. Licence Number 2022/OSI_NMA_180 National Transport Authority. All elevations are in metres and relate to OSI Geoid Model (OSGM15) Mean Head. All Co-ordinates are in Irish Transverse Mercator Grid (ITM) as defined by OSI active local GPS station.

d. Information concerning the position of apparatus shown on this drawing is based on drawings supplied by the utility owners and/or the utility works contractor, whilst every care has been taken in the preparation of this drawing, positions should be taken as approximate and are intended for general guidance only and no representation is made by the NTA as to the accuracy, completeness, sufficiency or otherwise of this drawing and the position of the apparatus. The information contained herein does not purport to be comprehensive or final as the apparatus is subject to being altered and/or superceded. Recipients should not rely on this information. Any liabilities are hereby expressly disclaimed.

e. The information contained herein has been provided by the NTA but does not purport to be comprehensive or final. Recipients should not rely on the information. Neither the NTA nor any of its directors, officers, employees, agents, stakeholders or advisers make any representation or warranty as to, or accept any liability or responsibility in relation to, the adequacy, accuracy, reasonableness or completeness of the information provided as part of this document or any matter on which the information is based (including but not limited to loss or damage arising as a result of reliance by recipients on the information or any part of it). Any liabilities are hereby expressly disclaimed.



| Rev | Date | Drn | Chk'd | App'd | Description |
|-----|----------|-----|-------|-------|-----------------------------|
| M01 | MAR 2023 | SCH | EFD | SMG | ISSUE FOR PHASE 4: PLANNING |

Client: **NTA**
Údarás Náisiúnta Iompair
National Transport Authority

Engineering Designer: **CIROD**
CIROD TYPSA

Date: MAR 2023
Scale: 1:500 @ A1
1:1,000 @ A3

Programme Code: BCIDD
Originator Code: ROT

Drawn: SCH
Checked: EFD
Approved: SMG

| | | | |
|---|------------------------|-----------|----------|
| Programme Title: BUSCONNECTS DUBLIN CORE BUS CORRIDORS INFRASTRUCTURE WORKS | | | |
| Drawing Title: RINGSEND TO CITY CENTRE CORE BUS CORRIDOR SCHEME PAVEMENT TREATMENT PLANS | | | |
| Drawing File Name: BCIDD-ROT-PAV_PV-0016_XX_00-DR-CR-0006 | Sheet Number: 06 of 12 | Status: A | Rev: M01 |

DO NOT SCALE USE FIGURED DIMENSIONS ONLY

\\vodubp1\U201917\171117-02_WIP\08 MODELS\01 CAD\01 DWG\03 STG 3 - STATUTORY PROCESS (M)\01 PLANNING\16 RINGSEND\BCIDD-ROT-PAV_PV-0016_XX_00-DR-CR-0001.dwg



RIVER LIFFEY

EAST LINK TOLL BOOTH

YORK ROAD

EAST LINK ROAD

PIGEON HOUSE ROAD

RINGSEND PARK

RINGSEND COLLEGE

CAMBRIDGE ROAD

E 40100 E 40150 E 40200 E 40250 E 40300 E 40350 E 40400 E 40450

SHEET 06 SHEET 07

SHEET 07 SHEET 08

LEGEND:

- PROPOSED OVERLAY
- PROPOSED SURFACE AND BINDER
- PROPOSED SURFACE, BINDER & BASE
- PROPOSED FULL DEPTH CONSTRUCTION
- PROPOSED FOOTPATH CONSTRUCTION
- PROPOSED CYCLE TRACK CONSTRUCTION
- SITE BOUNDARY LINE
- TEMPORARY LAND ACQUISITION



Disclaimer

a. © National Transport Authority (NTA) 2022. This drawing is confidential and the copyright in it is owned by NTA. This drawing must not be either loaned, copied or otherwise reproduced in whole or in part or used for any purpose without the prior permission of NTA.

b. This drawing is to be used for the design element identified in the titlebox. Other information shown is to be considered indicative only. The drawing is to be read in conjunction with all other relevant design drawings.

c. O.S. data used for plans are printed under © Ordnance Survey Ireland Government of Ireland. All rights reserved. Licence Number 2022/OSI_NMA_180 National Transport Authority. All elevations are in metres and relate to OSI Geoid Model (OSGM15) Mean Head. All Co-ordinates are in Irish Transverse Mercator Grid (ITM) as defined by OSI active local GPS station.

d. Information concerning the position of apparatus shown on this drawing is based on drawings supplied by the utility owners and/or the utility works contractor, whilst every care has been taken in the preparation of this drawing, positions should be taken as approximate and are intended for general guidance only and no representation is made by the NTA as to the accuracy, completeness, sufficiency or otherwise of this drawing and the position of the apparatus. The information contained herein does not purport to be comprehensive or final as the apparatus is subject to being altered and/or superceded. Recipients should not rely on this information. Any liabilities are hereby expressly disclaimed.

e. The information contained herein has been provided by the NTA but does not purport to be comprehensive or final. Recipients should not rely on the information. Neither the NTA nor any of its directors, officers, employees, agents, stakeholders or advisers make any representation or warranty as to, or accept any liability or responsibility in relation to, the adequacy, accuracy, reasonableness or completeness of the information provided as part of this document or any matter on which the information is based (including but not limited to loss or damage arising as a result of reliance by recipients on the information or any part of it). Any liabilities are hereby expressly disclaimed.



| Rev | Date | Drn | Chk'd | App'd | Description |
|-----|----------|-----|-------|-------|-----------------------------|
| M01 | MAR 2023 | SCH | EFD | SMG | ISSUE FOR PHASE 4: PLANNING |

Client: **NTA**
Údarás Náisiúnta Iompair
National Transport Authority

Engineering Designer: **CIROD**
TYPSA

Date: MAR 2023
Scale: 1:500 @ A1
1:1,000 @ A3

Drawn: SCH
Checked: EFD
Approved: SMG

Programme Code: BCIDD
Originator Code: ROT
QMS Code:

| | | | |
|---|--------------------------|-------------|------------|
| Programme Title BUSCONNECTS DUBLIN CORE BUS CORRIDORS INFRASTRUCTURE WORKS | | | |
| Drawing Title RINGSEND TO CITY CENTRE CORE BUS CORRIDOR SCHEME PAVEMENT TREATMENT PLANS | | | |
| Drawing File Name BCIDD-ROT-PAV_PV-0016_XX_00-DR-CR-0007 | Sheet Number 07 of 12 | Status A | Rev M01 |

DO NOT SCALE USE FIGURED DIMENSIONS ONLY

\\vodubp1\U201919\17117-02_WIP\08 MODELS\01 CAD\01 PLANNING\16 RINGSEND\BCIDD-ROT-PAV_PV-0016_XX_00-DR-CR-0001.dwg

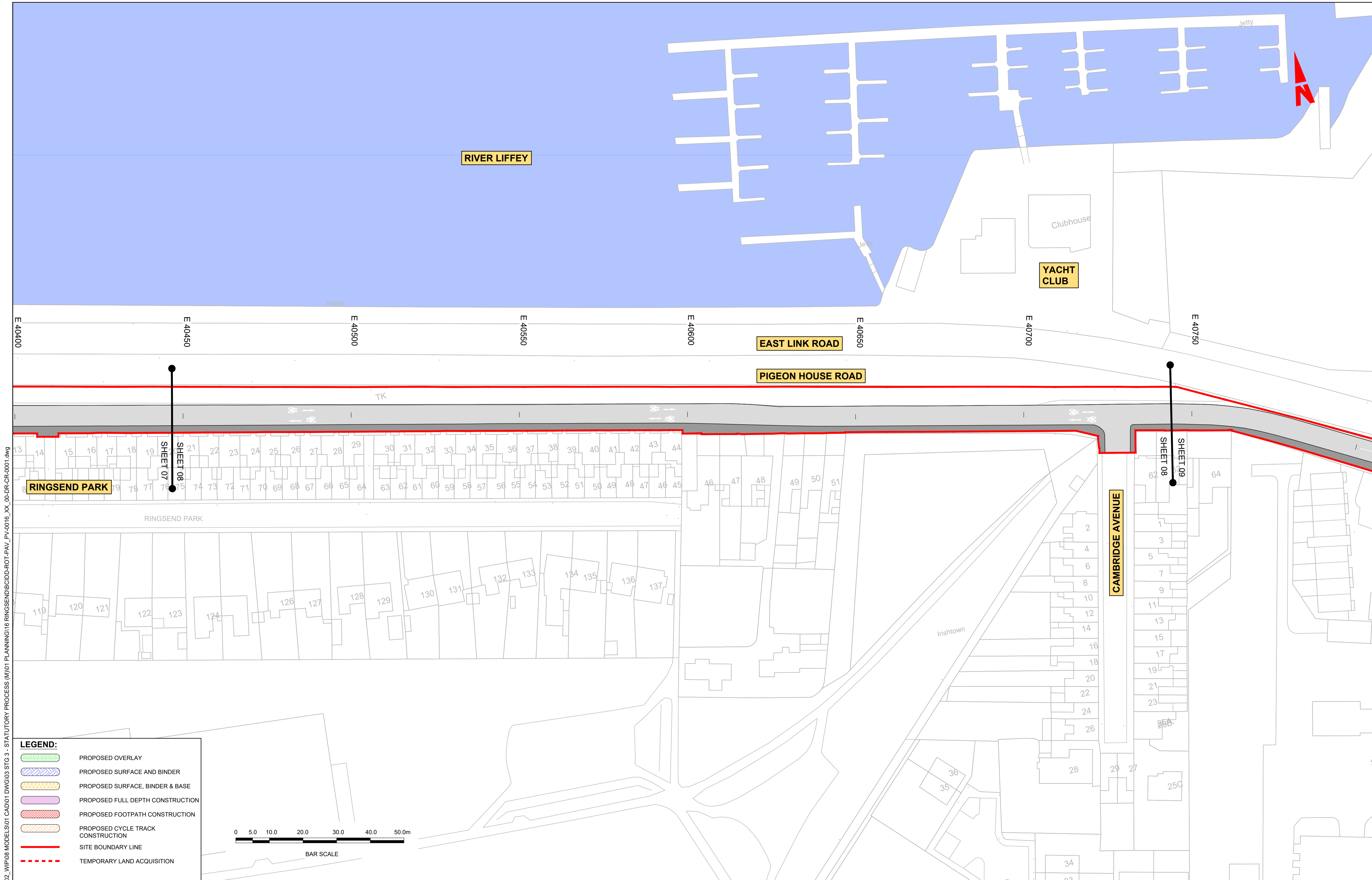

LEGEND:

- PROPOSED OVERLAY
- PROPOSED SURFACE AND BINDER
- PROPOSED SURFACE, BINDER & BASE
- PROPOSED FULL DEPTH CONSTRUCTION
- PROPOSED FOOTPATH CONSTRUCTION
- PROPOSED CYCLE TRACK CONSTRUCTION
- SITE BOUNDARY LINE
- TEMPORARY LAND ACQUISITION

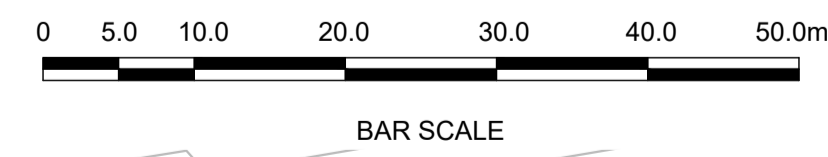

\\vodubp1\U201919\17117-02_WIP\08 MODELS\01 CAD\01 DWG\03 STG 3 - STATUTORY PROCESS (M)\01 PLANNING\16 RINGSEND\BCIDD-ROT-PAV_PV-0016_XX_00-DR-CR-0001.dwg

Disclaimer

a. © National Transport Authority (NTA) 2022. This drawing is confidential and the copyright in it is owned by NTA. This drawing must not be either loaned, copied or otherwise reproduced in whole or in part or used for any purpose without the prior permission of NTA.

b. This drawing is to be used for the design element identified in the titlebox. Other information shown is to be considered indicative only. The drawing is to be read in conjunction with all other relevant design drawings.

c. O.S. data used for plans are printed under © Ordnance Survey Ireland Government of Ireland. All rights reserved. Licence Number 2022/OSI_NMA_180 National Transport Authority. All elevations are in metres and relate to OSI Geoid Model (OSGM15) Mean Head. All Co-ordinates are in Irish Transverse Mercator Grid (ITM) as defined by OSI active local GPS station.

d. Information concerning the position of apparatus shown on this drawing is based on drawings supplied by the utility owners and/or the utility works contractor, whilst every care has been taken in the preparation of this drawing, positions should be taken as approximate and are intended for general guidance only and no representation is made by the NTA as to the accuracy, completeness, sufficiency or otherwise of this drawing and the position of the apparatus. The information contained herein does not purport to be comprehensive or final as the apparatus is subject to being altered and/or superseded. Recipients should not rely on this information. Any liabilities are hereby expressly disclaimed.

e. The information contained herein has been provided by the NTA but does not purport to be comprehensive or final. Recipients should not rely on the information. Neither the NTA nor any of its directors, officers, employees, agents, stakeholders or advisers make any representation or warranty as to, or accept any liability or responsibility in relation to, the adequacy, accuracy, reasonableness or completeness of the information provided as part of this document or any matter on which the information is based (including but not limited to loss or damage arising as a result of reliance by recipients on the information or any part of it). Any liabilities are hereby expressly disclaimed.



| Rev | Date | Drn | Chk'd | App'd | Description |
|-----|----------|-----|-------|-------|-----------------------------|
| M01 | MAR 2023 | SCH | EFD | SMG | ISSUE FOR PHASE 4: PLANNING |

Client: **NTA**
Údarás Náisiúnta Iompair
National Transport Authority

Engineering Designer: **CIROD**
TYPSA

Date: MAR 2023
Scale: 1:500 @ A1
1:1,000 @ A3

Drawn: SCH
Checked: EFD
Approved: SMG

Programme Code: BCIDD
Originator Code: ROT
QMS Code:

| | | | |
|---|--------------------------|-------------|------------|
| Programme Title BUSCONNECTS DUBLIN CORE BUS CORRIDORS INFRASTRUCTURE WORKS | | | |
| Drawing Title RINGSEND TO CITY CENTRE CORE BUS CORRIDOR SCHEME PAVEMENT TREATMENT PLANS | | | |
| Drawing File Name BCIDD-ROT-PAV_PV-0016_XX_00-DR-CR-0008 | Sheet Number 08 of 12 | Status A | Rev M01 |

DO NOT SCALE USE FIGURED DIMENSIONS ONLY

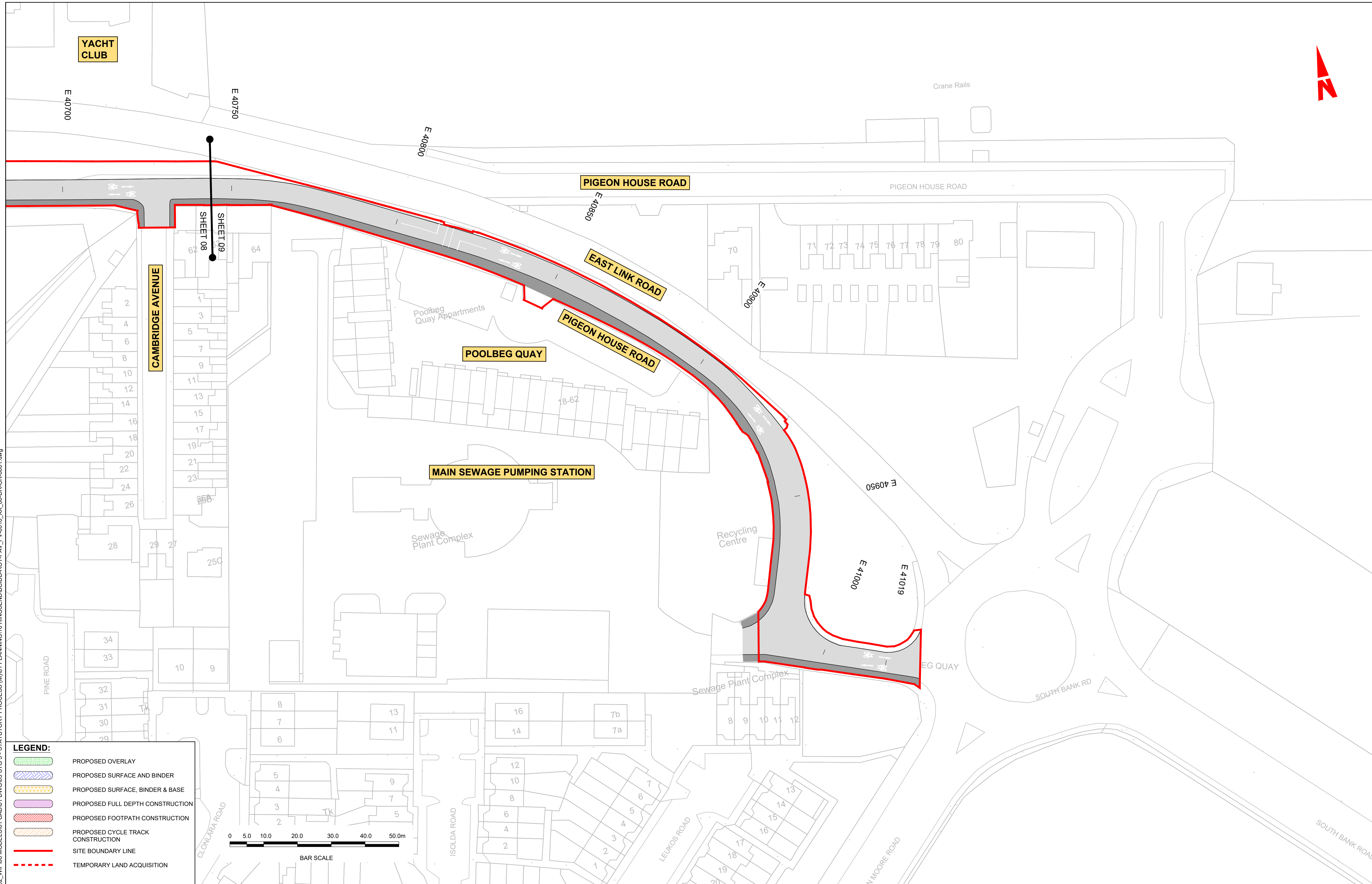
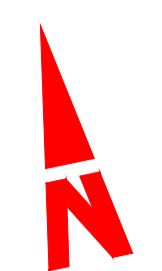

LEGEND:

- PROPOSED OVERLAY
- PROPOSED SURFACE AND BINDER
- PROPOSED SURFACE, BINDER & BASE
- PROPOSED FULL DEPTH CONSTRUCTION
- PROPOSED FOOTPATH CONSTRUCTION
- PROPOSED CYCLE TRACK CONSTRUCTION
- SITE BOUNDARY LINE
- TEMPORARY LAND ACQUISITION

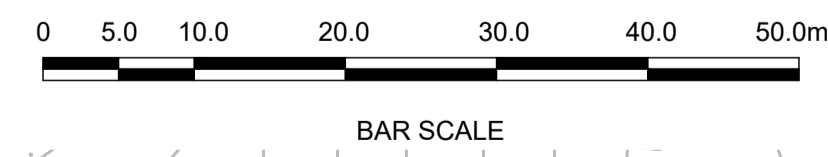

Disclaimer
 a. © National Transport Authority (NTA) 2022. This drawing is confidential and the copyright in it is owned by NTA. This drawing must not be either loaned, copied or otherwise reproduced in whole or in part or used for any purpose without the prior permission of NTA.
 b. This drawing is to be used for the design element identified in the titleblock. Other information shown is to be considered indicative only. The drawing is to be read in conjunction with all other relevant design drawings.
 c. O.S. data used for plans are printed under © Ordnance Survey Ireland Government of Ireland. All rights reserved. Licence Number 2022/OSI_NMA_180 National Transport Authority. All elevations are in metres and relate to OSI Geoid Model (OSGM15) Mean Head. All Co-ordinates are in Irish

Transverse Mercator Grid (ITM) as defined by OSI active local GPS station.
 d. Information concerning the position of apparatus shown on this drawing is based on drawings supplied by the utility owners and/or the utility works contractor, whilst every care has been taken in the preparation of this drawing, positions should be taken as approximate and are intended for general guidance only and no representation is made by the NTA as to the accuracy, completeness, sufficiency or otherwise of this drawing and the position of the apparatus. The information contained herein does not purport to be comprehensive or final as the apparatus is subject to being altered and/or superseded. Recipients should not rely on this information. Any liabilities are hereby expressly disclaimed.

e. The information contained herein has been provided by the NTA but does not purport to be comprehensive or final. Recipients should not rely on the information. Neither the NTA nor any of its directors, officers, employees, agents, stakeholders or advisers make any representation or warranty as to, or accept any liability or responsibility in relation to, the adequacy, accuracy, reasonableness or completeness of the information provided as part of this document or any matter on which the information is based (including but not limited to loss or damage arising as a result of reliance by recipients on the information or any part of it). Any liabilities are hereby expressly disclaimed.



| Rev | Date | Drn | Chk'd | App'd | Description |
|-----|----------|-----|-------|-------|-----------------------------|
| M01 | MAR 2023 | SCH | EFD | SMG | ISSUE FOR PHASE 4: PLANNING |

Client

 Údarás Náisiúnta Iompair
 National Transport Authority

| Engineering Designer | | |
|----------------------|----------------------------|----------|
| Date | Scale | Drawn |
| MAR 2023 | 1:500 @ A1 1:1,000 @ A3 | SCH |
| Programme Code | Originator Code | Checked |
| BCIDD | ROT | EFD |
| | | Approved |
| | | SMG |

| Programme Title | | | |
|--|--------------|--------|-----|
| BUSCONNECTS DUBLIN CORE BUS CORRIDORS INFRASTRUCTURE WORKS | | | |
| Drawing Title | | | |
| RINGSEND TO CITY CENTRE CORE BUS CORRIDOR SCHEME PAVEMENT TREATMENT PLANS | | | |
| Drawing File Name | Sheet Number | Status | Rev |
| BCIDD-ROT-PAV_PV-0016_XX_00-DR-CR-0009 | 09 of 12 | A | M01 |

DO NOT SCALE USE FIGURED DIMENSIONS ONLY

\\nodubp1\U201917\171117-02_WIP\08 MODELS\01 CAD\01 PLANNING\16 RINGSEND\BCIDD-ROT-PAV_PV-0016_XX_00-DR-CR-0001.dwg

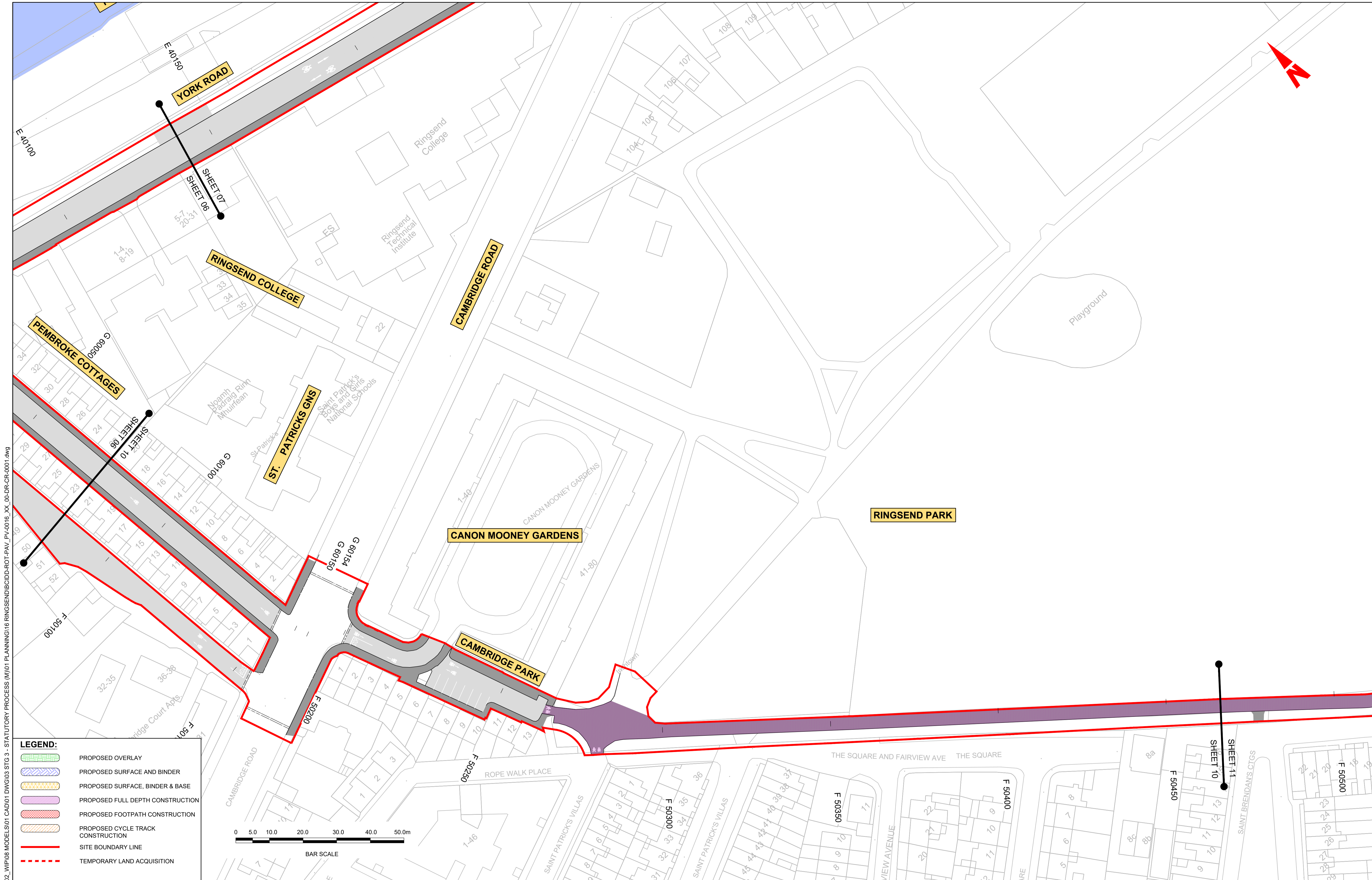

W:\000000\171117-02_WIP\08 MODELS\01 CAD\01 PLANNING\16 RINGSEND\BCIDD-ROT-PAV_PV-0016_XX_00-DR-CR-0001.dwg
 171117-02 - STATUTORY PROCESS (M)\01 PLANNING\16 RINGSEND\BCIDD-ROT-PAV_PV-0016_XX_00-DR-CR-0001.dwg

LEGEND:

- PROPOSED OVERLAY
- PROPOSED SURFACE AND BINDER
- PROPOSED SURFACE, BINDER & BASE
- PROPOSED FULL DEPTH CONSTRUCTION
- PROPOSED FOOTPATH CONSTRUCTION
- PROPOSED CYCLE TRACK CONSTRUCTION
- SITE BOUNDARY LINE
- TEMPORARY LAND ACQUISITION

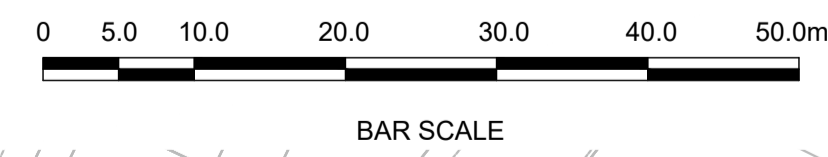

Disclaimer

a. © National Transport Authority (NTA) 2022. This drawing is confidential and the copyright in it is owned by NTA. This drawing must not be either loaned, copied or otherwise reproduced in whole or in part or used for any purpose without the prior permission of NTA.

b. This drawing is to be used for the design element identified in the titleblock. Other information shown is to be considered indicative only. The drawing is to be read in conjunction with all other relevant design drawings.

c. O.S. data used for plans are printed under © Ordnance Survey Ireland Government of Ireland. All rights reserved. Licence Number 2022/OSI_NMA_180 National Transport Authority. All elevations are in metres and relate to OSI Geoid Model (OSGM15) Mean Head. All Co-ordinates are in Irish Transverse Mercator Grid (ITM) as defined by OSI active local GPS station.

d. Information concerning the position of apparatus shown on this drawing is based on drawings supplied by the utility owners and/or the utility works contractor, whilst every care has been taken in the preparation of this drawing, positions should be taken as approximate and are intended for general guidance only and no representation is made by the NTA as to the accuracy, completeness, sufficiency or otherwise of this drawing and the position of the apparatus. The information contained herein does not purport to be comprehensive or final as the apparatus is subject to being altered and/or superceded. Recipients should not rely on this information. Any liabilities are hereby expressly disclaimed.

e. The information contained herein has been provided by the NTA but does not purport to be comprehensive or final. Recipients should not rely on the information. Neither the NTA nor any of its directors, officers, employees, agents, stakeholders or advisers make any representation or warranty as to, or accept any liability or responsibility in relation to, the adequacy, accuracy, reasonableness or completeness of the information provided as part of this document or any matter on which the information is based (including but not limited to loss or damage arising as a result of reliance by recipients on the information or any part of it). Any liabilities are hereby expressly disclaimed.



| Rev | Date | Drn | Chk'd | App'd | Description |
|-----|----------|-----|-------|-------|-----------------------------|
| M01 | MAR 2023 | SCH | EFD | SMG | ISSUE FOR PHASE 4: PLANNING |

Client: **NTA**
 Údarás Náisiúnta Iompair
 National Transport Authority

Engineering Designer: **CIROD**
 TYPSA

Date: MAR 2023
 Scale: 1:500 @ A1
 1:1,000 @ A3

Drawn: SCH
 Checked: EFD
 Approved: SMG

Programme Code: BCIDD
 Originator Code: ROT
 QMS Code:

| | | | |
|---|--------------------------|-------------|------------|
| Programme Title BUSCONNECTS DUBLIN CORE BUS CORRIDORS INFRASTRUCTURE WORKS | | | |
| Drawing Title RINGSEND TO CITY CENTRE CORE BUS CORRIDOR SCHEME PAVEMENT TREATMENT PLANS | | | |
| Drawing File Name BCIDD-ROT-PAV_PV-0016_XX_00-DR-CR-0010 | Sheet Number 10 of 12 | Status A | Rev M01 |

DO NOT SCALE USE FIGURED DIMENSIONS ONLY

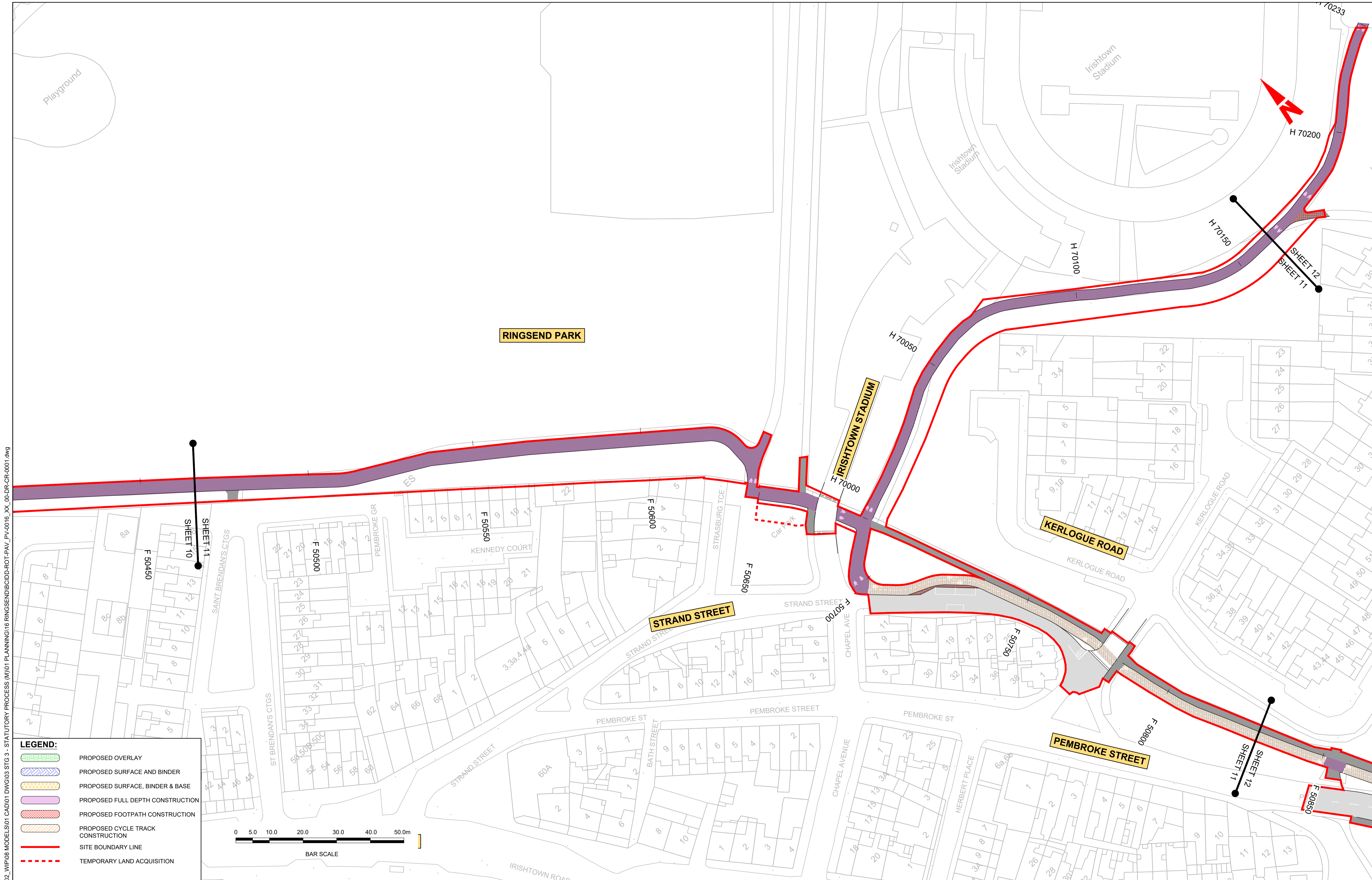

LEGEND:

- PROPOSED OVERLAY
- PROPOSED SURFACE AND BINDER
- PROPOSED SURFACE, BINDER & BASE
- PROPOSED FULL DEPTH CONSTRUCTION
- PROPOSED FOOTPATH CONSTRUCTION
- PROPOSED CYCLE TRACK CONSTRUCTION
- SITE BOUNDARY LINE
- TEMPORARY LAND ACQUISITION

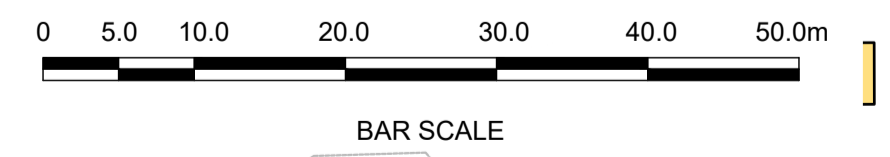

Disclaimer

a. © National Transport Authority (NTA) 2022. This drawing is confidential and the copyright in it is owned by NTA. This drawing must not be either loaned, copied or otherwise reproduced in whole or in part or used for any purpose without the prior permission of NTA.

b. This drawing is to be used for the design element identified in the titlebox. Other information shown is to be considered indicative only. The drawing is to be read in conjunction with all other relevant design drawings.

c. O.S. data used for plans are printed under © Ordnance Survey Ireland Government of Ireland. All rights reserved. Licence Number 2022/OSI_NMA_180 National Transport Authority. All elevations are in metres and relate to OSI Geoid Model (OSGM15) Mean Head. All Co-ordinates are in Irish Transverse Mercator Grid (ITM) as defined by OSI active local GPS station.

d. Information concerning the position of apparatus shown on this drawing is based on drawings supplied by the utility owners and/or the utility works contractor, whilst every care has been taken in the preparation of this drawing, positions should be taken as approximate and are intended for general guidance only and no representation is made by the NTA as to the accuracy, completeness, sufficiency or otherwise of this drawing and the position of the apparatus. The information contained herein does not purport to be comprehensive or final as the apparatus is subject to being altered and/or superceded. Recipients should not rely on this information. Any liabilities are hereby expressly disclaimed.

e. The information contained herein has been provided by the NTA but does not purport to be comprehensive or final. Recipients should not rely on the information. Neither the NTA nor any of its directors, officers, employees, agents, stakeholders or advisers make any representation or warranty as to, or accept any liability or responsibility in relation to, the adequacy, accuracy, reasonableness or completeness of the information provided as part of this document or any matter on which the information is based (including but not limited to loss or damage arising as a result of reliance by recipients on the information or any part of it). Any liabilities are hereby expressly disclaimed.



| Rev | Date | Drn | Chk'd | App'd | Description |
|-----|----------|-----|-------|-------|-----------------------------|
| M01 | MAR 2023 | SCH | EFD | SMG | ISSUE FOR PHASE 4: PLANNING |

Client: **NTA**
Udarás Náisiúnta Iompair
National Transport Authority

Engineering Designer: **CIROD**
TYPSA

Date: MAR 2023 | Scale: 1:500 @ A1, 1:1,000 @ A3 | Drawn: SCH | Checked: EFD | Approved: SMG

Programme Code: BCIDD | Originator Code: ROT | QMS Code:

| | | | |
|--|------------------------|-----------|----------|
| Programme Title: BUSCONNECTS DUBLIN CORE BUS CORRIDORS INFRASTRUCTURE WORKS | | | |
| Drawing Title: RINGSEND TO CITY CENTRE CORE BUS CORRIDOR SCHEME PAVEMENT TREATMENT PLANS | | | |
| Drawing File Name: BCIDD-ROT-PAV_PV-0016_XX_00-DR-CR-0011 | Sheet Number: 11 of 12 | Status: A | Rev: M01 |

DO NOT SCALE USE FIGURED DIMENSIONS ONLY

\\produbp1\U201917\17117-02_WIP08 MODELS\01 CAD\01 DWG\03 STG 3 - STATUTORY PROCESS (M)\01 PLANNING\16 RINGSEND\BCIDD-ROT-PAV_PV-0016_XX_00-DR-CR-0001.dwg

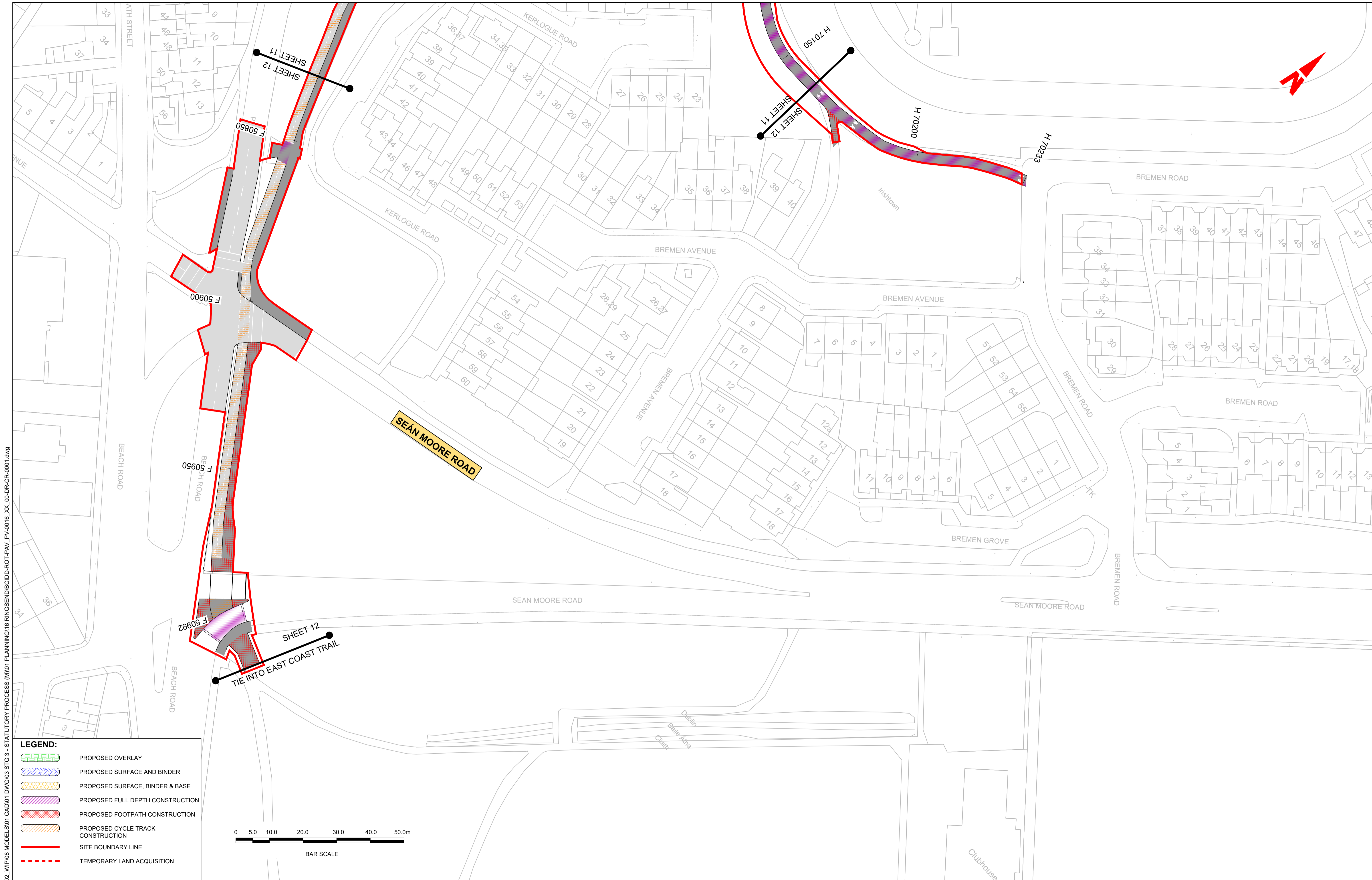

LEGEND:

- PROPOSED OVERLAY
- PROPOSED SURFACE AND BINDER
- PROPOSED SURFACE, BINDER & BASE
- PROPOSED FULL DEPTH CONSTRUCTION
- PROPOSED FOOTPATH CONSTRUCTION
- PROPOSED CYCLE TRACK CONSTRUCTION
- SITE BOUNDARY LINE
- TEMPORARY LAND ACQUISITION



\\nodubp1\j\2019\1917\19117-02_WIP\08 MODELS\01 CAD\01 PLANNING\16 RINGSEND\BCIDD-ROT-PAV_PV-0016_XX_00-DR-CR-001.dwg

Disclaimer

a. © National Transport Authority (NTA) 2022. This drawing is confidential and the copyright in it is owned by NTA. This drawing must not be either loaned, copied or otherwise reproduced in whole or in part or used for any purpose without the prior permission of NTA.

b. This drawing is to be used for the design element identified in the titleblock. Other information shown is to be considered indicative only. The drawing is to be read in conjunction with all other relevant design drawings.

c. O.S. data used for plans are printed under © Ordnance Survey Ireland Government of Ireland. All rights reserved. Licence Number 2022/OSI_NMA_180 National Transport Authority. All elevations are in metres and relate to OSI Geoid Model (OSGM15) Mean Head. All Co-ordinates are in Irish Transverse Mercator Grid (ITM) as defined by OSI active local GPS station.

d. Information concerning the position of apparatus shown on this drawing is based on drawings supplied by the utility owners and/or the utility works contractor, whilst every care has been taken in the preparation of this drawing, positions should be taken as approximate and are intended for general guidance only and no representation is made by the NTA as to the accuracy, completeness, sufficiency or otherwise of this drawing and the position of the apparatus. The information contained herein does not purport to be comprehensive or final as the apparatus is subject to being altered and/or superseded. Recipients should not rely on this information. Any liabilities are hereby expressly disclaimed.

e. The information contained herein has been provided by the NTA but does not purport to be comprehensive or final. Recipients should not rely on the information. Neither the NTA nor any of its directors, officers, employees, agents, stakeholders or advisers make any representation or warranty as to, or accept any liability or responsibility in relation to, the adequacy, accuracy, reasonableness or completeness of the information provided as part of this document or any matter on which the information is based (including but not limited to loss or damage arising as a result of reliance by recipients on the information or any part of it). Any liabilities are hereby expressly disclaimed.



| Rev | Date | Drn | Chk'd | App'd | Description |
|-----|----------|-----|-------|-------|-----------------------------|
| M01 | MAR 2023 | SCH | EFD | SMG | ISSUE FOR PHASE 4: PLANNING |

| | | | | |
|--|----------------------------|--------------------------|---------|----------|
| Údarás Náisiúnta Iompair National Transport Authority | | Engineering Designer | | |
| Date | Scale | Drawn | Checked | Approved |
| MAR 2023 | 1:500 @ A1 1:1,000 @ A3 | SCH | EFD | SMG |
| Programme Code | Originator Code | QMS Code | | |
| BCIDD | ROT | | | |

| | | | |
|--|--------------|--------|-----|
| Programme Title BUSCONNECTS DUBLIN CORE BUS CORRIDORS INFRASTRUCTURE WORKS | | | |
| Drawing Title RINGSEND TO CITY CENTRE CORE BUS CORRIDOR SCHEME PAVEMENT TREATMENT PLANS | | | |
| Drawing File Name | Sheet Number | Status | Rev |
| BCIDD-ROT-PAV_PV-0016_XX_00-DR-CR-0012 | 12 of 12 | A | M01 |

DO NOT SCALE USE FIGURED DIMENSIONS ONLY