

ESB Asset
Alterations





BUSCONNECTS DUBLIN CORE BUS CORRIDORS INFRASTRUCTURE WORKS

RINGSEND TO CITY CENTRE CORE BUS CORRIDOR SCHEME

DRAWING SERIES NUMBER(S)	DRAWING SERIES DESCRIPTION
BCIDD-ROT-UTL_IX-0016_XX_00-DR-CU-0003	RINGSEND TO CITY CENTRE CORE BUS CORRIDOR SCHEME. ESB ASSET ALTERATIONS. COVER SHEET
BCIDD-ROT-UTL_KP-0016_XX_00-DR-CU-0003	RINGSEND TO CITY CENTRE CORE BUS CORRIDOR SCHEME. ESB ASSET ALTERATIONS. KEY PLAN
BCIDD-ROT-UTL_UE-0016_XX_00-DR-CU-0001 to 0012	RINGSEND TO CITY CENTRE CORE BUS CORRIDOR SCHEME. ESB ASSET ALTERATIONS. DRAWINGS.

D:\Projects\RingSend\Drawings\0003\BCIDD-ROT-UTL_IX-0016_XX_00-DR-CU-0003.dwg

ST GEORGES CHANNEL

Disclaimer

a. © National Transport Authority (NTA) 2022. This drawing is confidential and the copyright in it is owned by NTA. This drawing must not be either loaned, copied or otherwise reproduced in whole or in part or used for any purpose without the prior permission of NTA.

b. This drawing is to be used for the design element identified in the titlebox. Other information shown is to be considered indicative only. The drawing is to be read in conjunction with all other relevant design drawings.

c. O.S. data used for plans are printed under © Ordnance Survey Ireland Government of Ireland. All rights reserved. Licence Number 2022/OSI_NMA_180 National Transport Authority. All elevations are in metres and relate to OSi Geoid Model (OSGM15) Mean Head. All Co-ordinates are in Irish Transverse Mercator Grid (ITM) as defined by OSI active local GPS station.

d. Information concerning the position of apparatus shown on this drawing is based on drawings supplied by the utility owners and/or the utility works contractor, whilst every care has been taken in the preparation of this drawing, positions should be taken as approximate and are intended for general guidance only and no representation is made by the NTA as to the accuracy, completeness, sufficiency or otherwise of this drawing and the position of the apparatus. The information contained herein does not purport to be comprehensive or final as the apparatus is subject to being altered and/or superceded. Recipients should not rely on this information. Any liabilities are hereby expressly disclaimed.

e. The information contained herein has been provided by the NTA but does not purport to be comprehensive or final. Recipients should not rely on the information. Neither the NTA nor any of its directors, officers, employees, agents, stakeholders or advisers make any representation or warranty as to, or accept any liability or responsibility in relation to, the adequacy, accuracy, reasonableness or completeness of the information provided as part of this document or any matter on which the information is based (including but not limited to loss or damage arising as a result of reliance by recipients on the information or any part of it). Any liabilities are hereby expressly disclaimed.



Rev	Date	Drn	Chk'd	App'd	Description
M01	MAR 2023	CG	EOC	SMG	ISSUE FOR PHASE 4: PLANNING

NTA Údarás Náisiúnta Iompair National Transport Authority		Engineering Designer IROD TYPESA ROUGHAN & O'DONOVAN		
Date	Scale	Drawn	Checked	Approved
MAR 2023	NTS @ A1 NTS @ A3	CG	EOC	SMG
Programme Code	Originator Code	QMS Code		
BCIDD	ROT			

Programme Title BUSCONNECTS DUBLIN CORE BUS CORRIDORS INFRASTRUCTURE WORKS			
Drawing Title RINGSEND TO CITY CENTRE CORE BUS CORRIDOR SCHEME ESB ASSET ALTERATIONS COVER SHEET			
Drawing File Name	Sheet Number	Status	Rev
BCIDD-ROT-UTL_IX-0016_XX_00-DR-CU-0003	01 of 01	A	M01

DO NOT SCALE USE FIGURED DIMENSIONS ONLY

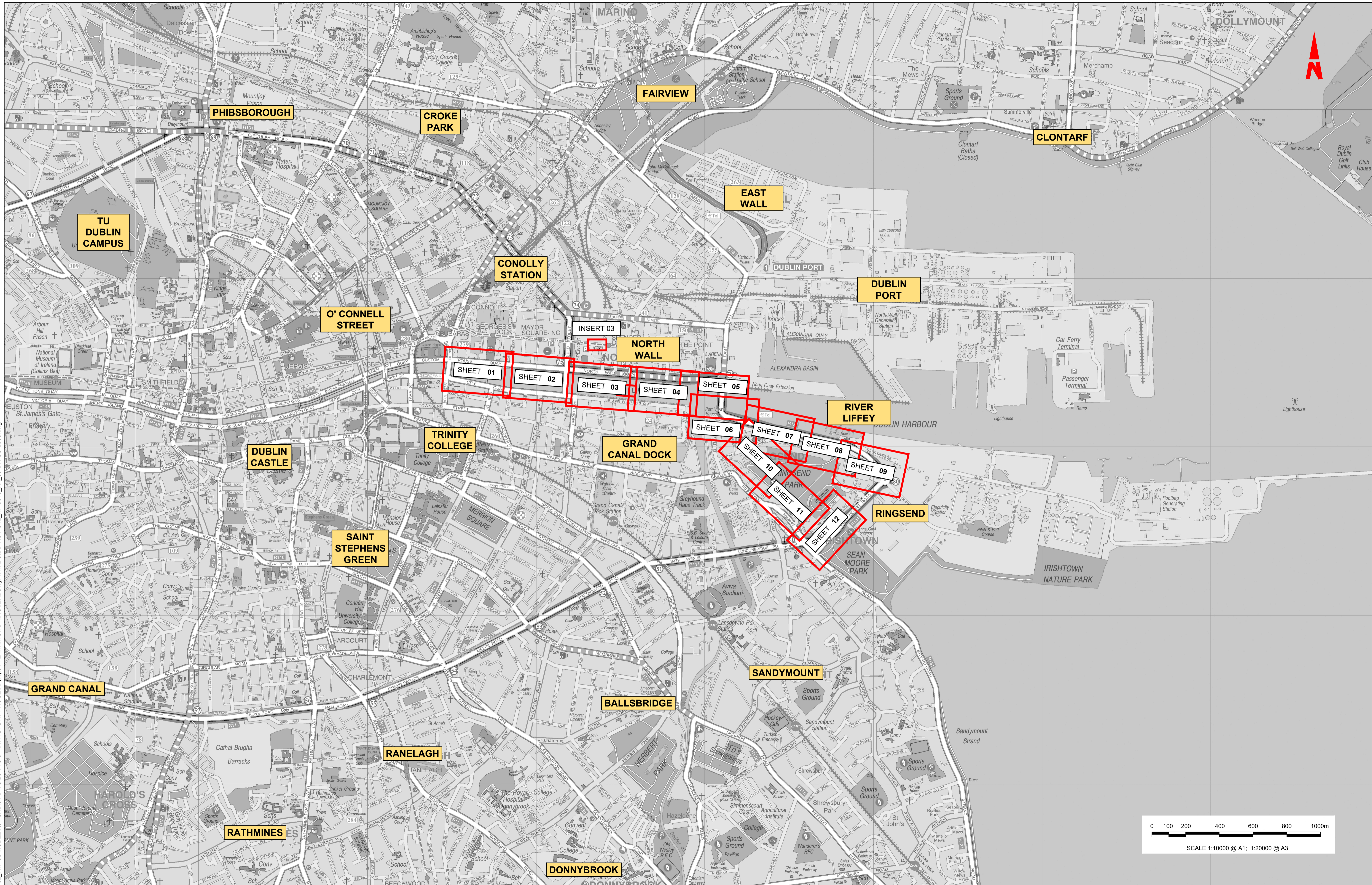

W:\dub\p\1917117-02_WIP\08 MODELS\01 CAD\01 PLANNING\16 RINGSEND\KEY\Plans\BCIDD-ROT-UTL_KP-0016_XX_00-DR-CU-0003.dwg
 W:\dub\p\1917117-02_WIP\08 MODELS\01 CAD\01 PLANNING\16 RINGSEND\KEY\Plans\BCIDD-ROT-UTL_KP-0016_XX_00-DR-CU-0003.dwg

Disclaimer
 a. © National Transport Authority (NTA) 2022. This drawing is confidential and the copyright in it is owned by NTA. This drawing must not be either loaned, copied or otherwise reproduced in whole or in part or used for any purpose without the prior permission of NTA.
 b. This drawing is to be used for the design element identified in the title block. Other information shown is to be considered indicative only. The drawing is to be read in conjunction with all other relevant design drawings.
 c. O.S. data used for plans are printed under © Ordnance Survey Ireland Government of Ireland. All rights reserved. Licence Number 2022/OSI_NMA_180 National Transport Authority. All elevations are in metres and relate to OSi Geoid Model (OSGM15) Mean Head. All Co-ordinates are in Irish

Transverse Mercator Grid (ITM) as defined by OSI active local GPS station.
 d. Information concerning the position of apparatus shown on this drawing is based on the data supplied by the utility owners, and/or the utility works contractor, whilst every care has been taken in the preparation of this drawing, positions should be taken as approximate and are provided for general guidance only and no representation is made by the NTA as to the accuracy, completeness, sufficiency or otherwise of this drawing and any information arising as a result of reliance on the information or any part of it. Any liabilities are hereby expressly disclaimed.

The information contained herein has been provided by the NTA but does not purport to be comprehensive or final. Recipients should not rely on the information. Neither the NTA nor any of its directors, officers, employees, agents, stakeholders or advisers make any representation or warranty as to, or accept any liability or responsibility in relation to, the adequacy, accuracy, reasonableness or completeness of the information provided as part of this document or any matter on which the information is based (including but not limited to loss or damage arising as a result of reliance on the information or any part of it). Any liabilities are hereby expressly disclaimed.

Project Ireland 2040
 Building Ireland's Future

Rev	Date	Drn	Chk'd	App'd	Description
M01	MAR 2023	DS	EOC	SMG	ISSUE FOR PHASE 4: PLANNING

Client

 Údarás Náisiúnta Iompair
 National Transport Authority

Engineering Designer		
Drawn	Checked	Approved
DS	EOC	SMG

Programme Title			
BUSCONNECTS DUBLIN CORE BUS CORRIDORS INFRASTRUCTURE WORKS			
Drawing Title			
RINGSEND TO CITY CENTRE CORE BUS CORRIDOR SCHEME ESB ASSET ALTERATIONS KEY PLAN			
Drawing File Name	Sheet Number	Status	Rev
BCIDD-ROT-UTL_KP-0016_XX_00-DR-CU-0003	01 of 01	A	M01

DO NOT SCALE USE FIGURED DIMENSIONS ONLY

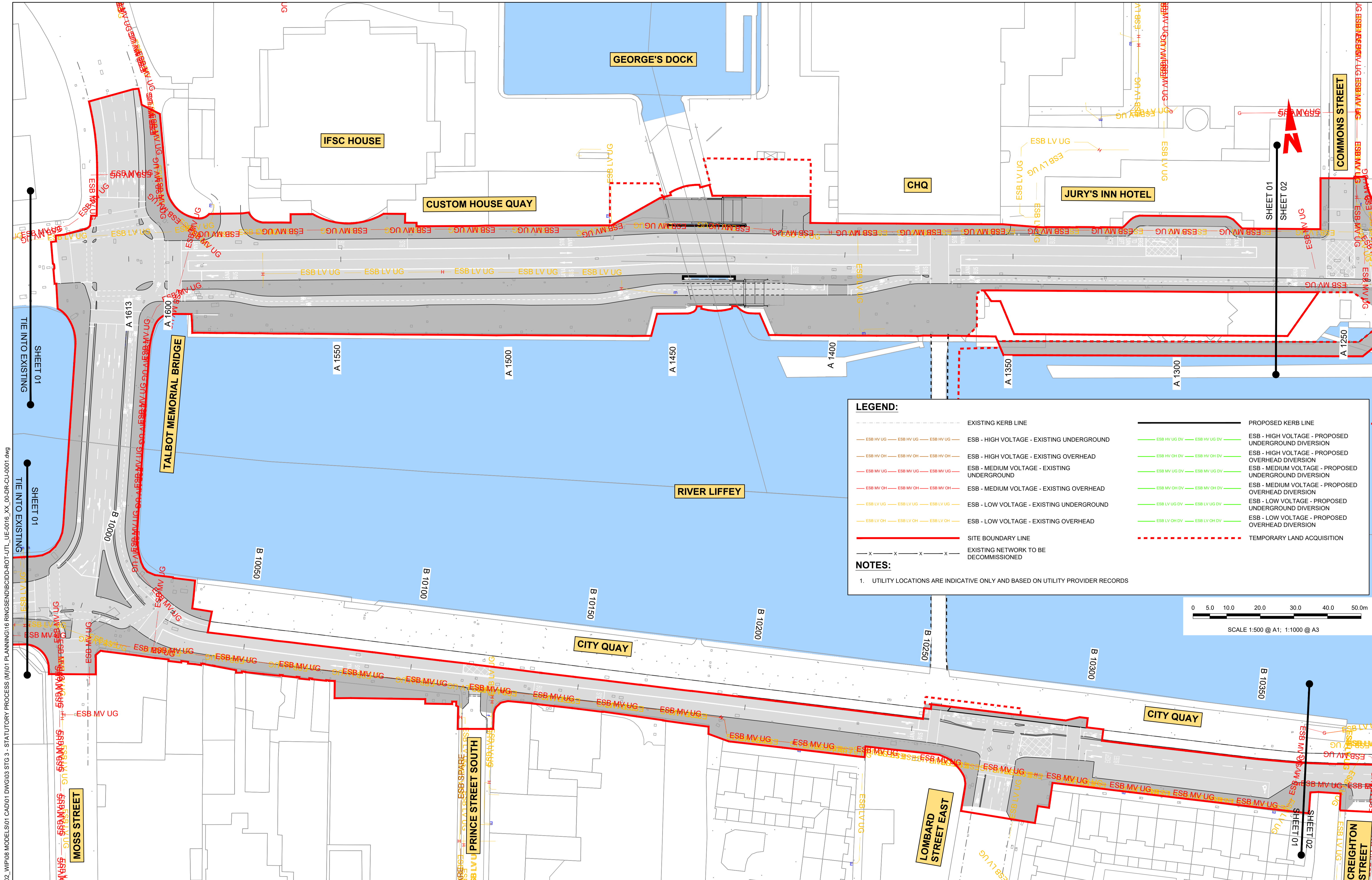

LEGEND:

	EXISTING KERB LINE		PROPOSED KERB LINE
	ESB - HIGH VOLTAGE - EXISTING UNDERGROUND		ESB - HIGH VOLTAGE - PROPOSED UNDERGROUND DIVERSION
	ESB - HIGH VOLTAGE - EXISTING OVERHEAD		ESB - HIGH VOLTAGE - PROPOSED OVERHEAD DIVERSION
	ESB - MEDIUM VOLTAGE - EXISTING UNDERGROUND		ESB - MEDIUM VOLTAGE - PROPOSED UNDERGROUND DIVERSION
	ESB - MEDIUM VOLTAGE - EXISTING OVERHEAD		ESB - MEDIUM VOLTAGE - PROPOSED OVERHEAD DIVERSION
	ESB - LOW VOLTAGE - EXISTING UNDERGROUND		ESB - LOW VOLTAGE - PROPOSED UNDERGROUND DIVERSION
	ESB - LOW VOLTAGE - EXISTING OVERHEAD		ESB - LOW VOLTAGE - PROPOSED OVERHEAD DIVERSION
	SITE BOUNDARY LINE		TEMPORARY LAND ACQUISITION
	EXISTING NETWORK TO BE DECOMMISSIONED		

NOTES:

- UTILITY LOCATIONS ARE INDICATIVE ONLY AND BASED ON UTILITY PROVIDER RECORDS

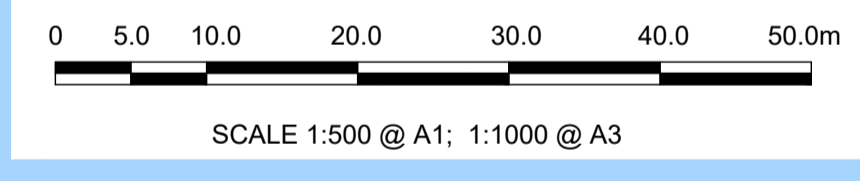

\\nodubp1u2019191717117-02_WIP08 MODELS01 CAD01 DWG003 STG 3 - STATUTORY PROCESS (M)01 PLANNING16 RINGSEND/BCIDD-ROT-UTL_UE-0016_XX_00-DR-CU-0001.dwg

Disclaimer

a. © National Transport Authority (NTA) 2022. This drawing is confidential and the copyright in it is owned by NTA. This drawing must not be either loaned, copied or otherwise reproduced in whole or in part or used for any purpose without the prior permission of NTA.

b. This drawing is to be used for the design element identified in the title block. Other information shown is to be considered indicative only. The drawing is to be read in conjunction with all other relevant design drawings.

c. O.S. data used for plans are printed under © Ordnance Survey Ireland Government of Ireland. All rights reserved. Licence Number 2022/OSI_NMA_180 National Transport Authority. All elevations are in metres and relate to OSI Geoid Model (OSGM15) Mean Head. All Co-ordinates are in Irish Transverse Mercator Grid (ITM) as defined by OSI active local GPS station.

d. Information concerning the position of apparatus shown on this drawing is based on drawings supplied by the utility owners and/or the utility works contractor, whilst every care has been taken in the preparation of this drawing, positions should be taken as approximate and are intended for general guidance only and no representation is made by the NTA as to the accuracy, completeness, sufficiency or otherwise of this drawing and the position of the apparatus. The information contained herein does not purport to be comprehensive or final as the apparatus is subject to being altered and/or superceded. Recipients should not rely on this information. Any liabilities are hereby expressly disclaimed.

e. The information contained herein has been provided by the NTA but does not purport to be comprehensive or final. Recipients should not rely on the information. Neither the NTA nor any of its directors, officers, employees, agents, stakeholders or advisers make any representation or warranty as to, or accept any liability or responsibility in relation to, the adequacy, accuracy, reasonableness or completeness of the information provided as part of this document or any matter on which the information is based (including but not limited to loss or damage arising as a result of reliance by recipients on the information or any part of it). Any liabilities are hereby expressly disclaimed.



Rev	Date	Drn	Chk'd	App'd	Description
M01	MAR 2023	DS	EOC	SMG	ISSUE FOR PHASE 4: PLANNING

Client: **NTA**
Údarás Náisiúnta Iompair
National Transport Authority

Engineering Designer: **CIROD**
TYPSA

Date: MAR 2023 | Scale: 1:500 @ A1, 1:1000 @ A3 | Drawn: DS | Checked: EOC | Approved: SMG

Programme Code: BCIDD | Originator Code: ROT | QMS Code:

Programme Title: BUSCONNECTS DUBLIN CORE BUS CORRIDORS INFRASTRUCTURE WORKS			
Drawing Title: RINGSEND TO CITY CENTRE CORE BUS CORRIDOR SCHEME ESB ASSET ALTERATIONS			
Drawing File Name: BCIDD-ROT-UTL_UE-0016_XX_00-DR-CU-0001	Sheet Number: 01 of 12	Status: A	Rev: M01

DO NOT SCALE USE FIGURED DIMENSIONS ONLY

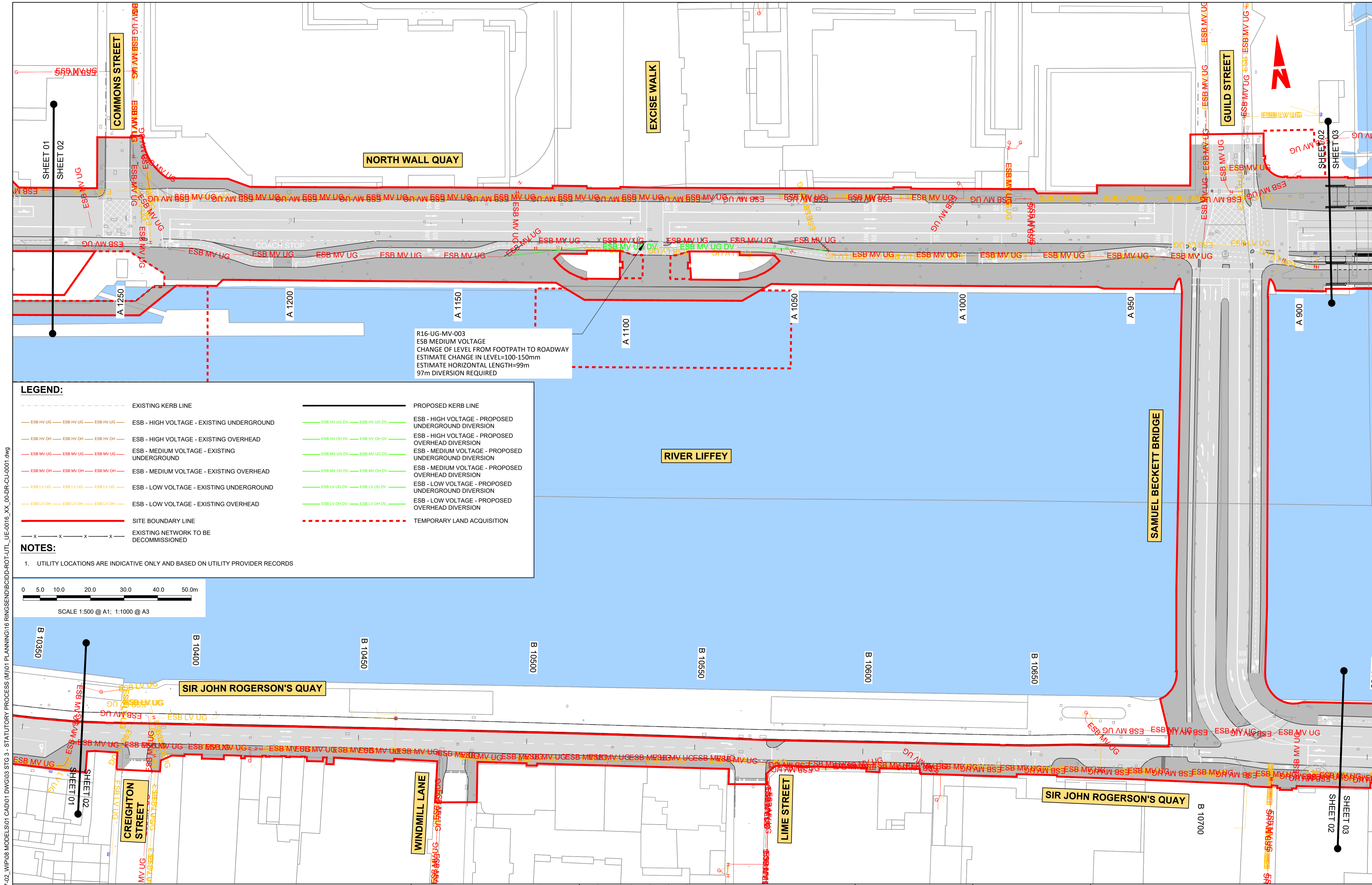

LEGEND:

--- EXISTING KERB LINE	--- PROPOSED KERB LINE
--- ESB HV UG --- ESB HV UG --- ESB HV UG --- ESB - HIGH VOLTAGE - EXISTING UNDERGROUND	--- ESB HV UG DV --- ESB HV UG DV --- ESB HV UG DV --- ESB - HIGH VOLTAGE - PROPOSED UNDERGROUND DIVERSION
--- ESB HV OH --- ESB HV OH --- ESB HV OH --- ESB - HIGH VOLTAGE - EXISTING OVERHEAD	--- ESB HV OH DV --- ESB HV OH DV --- ESB HV OH DV --- ESB - HIGH VOLTAGE - PROPOSED OVERHEAD DIVERSION
--- ESB MV UG --- ESB MV UG --- ESB MV UG --- ESB - MEDIUM VOLTAGE - EXISTING UNDERGROUND	--- ESB MV UG DV --- ESB MV UG DV --- ESB MV UG DV --- ESB - MEDIUM VOLTAGE - PROPOSED UNDERGROUND DIVERSION
--- ESB MV OH --- ESB MV OH --- ESB MV OH --- ESB - MEDIUM VOLTAGE - EXISTING OVERHEAD	--- ESB MV OH DV --- ESB MV OH DV --- ESB MV OH DV --- ESB - MEDIUM VOLTAGE - PROPOSED OVERHEAD DIVERSION
--- ESB LV UG --- ESB LV UG --- ESB LV UG --- ESB - LOW VOLTAGE - EXISTING UNDERGROUND	--- ESB LV UG DV --- ESB LV UG DV --- ESB LV UG DV --- ESB - LOW VOLTAGE - PROPOSED UNDERGROUND DIVERSION
--- ESB LV OH --- ESB LV OH --- ESB LV OH --- ESB - LOW VOLTAGE - EXISTING OVERHEAD	--- ESB LV OH DV --- ESB LV OH DV --- ESB LV OH DV --- ESB - LOW VOLTAGE - PROPOSED OVERHEAD DIVERSION
--- SITE BOUNDARY LINE	--- TEMPORARY LAND ACQUISITION
--- EXISTING NETWORK TO BE DECOMMISSIONED	

NOTES:

1. UTILITY LOCATIONS ARE INDICATIVE ONLY AND BASED ON UTILITY PROVIDER RECORDS

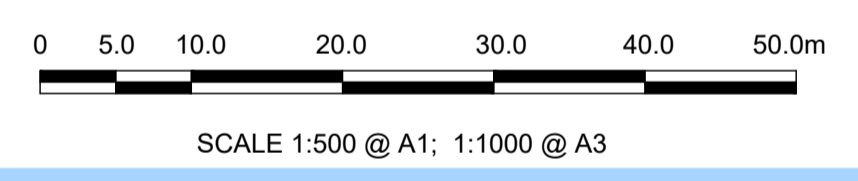

\\nodubp1u20191917117-02_WIP08 MODELS01 CAD01 DWG03 STG 3 - STATUTORY PROCESS (M)01 PLANNING16 RINGSEND/BCIDD-ROT-UTL_UE-0016_XX_00-DR-CU-0001.dwg

<p><small>Disclaimer</small></p> <p>a. © National Transport Authority (NTA) 2022. This drawing is confidential and the copyright in it is owned by NTA. This drawing must not be either loaned, copied or otherwise reproduced in whole or in part or used for any purpose without the prior permission of NTA.</p> <p>b. This drawing is to be used for the design element identified in the titleblock. Other information shown is to be considered indicative only. The drawing is to be read in conjunction with all other relevant design drawings.</p> <p>c. O.S. data used for plans are printed under © Ordnance Survey Ireland Government of Ireland. All rights reserved. Licence Number 2022/OSI_NMA_180 National Transport Authority. All elevations are in metres and relate to OSI Geoid Model (OSGM15) Mean Head. All Co-ordinates are in Irish Transverse Mercator Grid (ITM) as defined by OSI active local GPS station.</p> <p>d. Information concerning the position of apparatus shown on this drawing is based on drawings supplied by the utility owners and/or the utility works contractor, whilst every care has been taken in the preparation of this drawing, positions should be taken as approximate and are intended for general guidance only and no representation is made by the NTA as to the accuracy, completeness, sufficiency or otherwise of this drawing and the position of the apparatus. The information contained herein does not purport to be comprehensive or final as the apparatus is subject to being altered and/or superceded. Recipients should not rely on this information. Any liabilities are hereby expressly disclaimed.</p>		<table border="1"> <tr> <th>Rev</th> <th>Date</th> <th>Drn</th> <th>Chk'd</th> <th>App'd</th> <th>Description</th> </tr> <tr> <td>M01</td> <td>MAR 2023</td> <td>DS</td> <td>EOC</td> <td>SMG</td> <td>ISSUE FOR PHASE 4: PLANNING</td> </tr> </table>	Rev	Date	Drn	Chk'd	App'd	Description	M01	MAR 2023	DS	EOC	SMG	ISSUE FOR PHASE 4: PLANNING	<table border="1"> <tr> <td>Client</td> <td> Údarás Náisiúnta Iompair National Transport Authority </td> </tr> <tr> <td>Engineering Designer</td> <td> IROD Infrastructure Road TYPSA </td> </tr> </table>	Client	 Údarás Náisiúnta Iompair National Transport Authority	Engineering Designer	 IROD Infrastructure Road TYPSA	<table border="1"> <tr> <td>Programme Title</td> <td colspan="3">BUSCONNECTS DUBLIN CORE BUS CORRIDORS INFRASTRUCTURE WORKS</td> </tr> <tr> <td>Drawing Title</td> <td colspan="3">RINGSEND TO CITY CENTRE CORE BUS CORRIDOR SCHEME ESB ASSET ALTERATIONS</td> </tr> <tr> <td>Drawing File Name</td> <td>BCIDD-ROT-UTL_UE-0016_XX_00-DR-CU-0002</td> <td>Sheet Number</td> <td>02 of 12</td> </tr> <tr> <td>Status</td> <td>A</td> <td>Rev</td> <td>M01</td> </tr> </table>	Programme Title	BUSCONNECTS DUBLIN CORE BUS CORRIDORS INFRASTRUCTURE WORKS			Drawing Title	RINGSEND TO CITY CENTRE CORE BUS CORRIDOR SCHEME ESB ASSET ALTERATIONS			Drawing File Name	BCIDD-ROT-UTL_UE-0016_XX_00-DR-CU-0002	Sheet Number	02 of 12	Status	A	Rev	M01
		Rev	Date	Drn	Chk'd	App'd	Description																													
M01	MAR 2023	DS	EOC	SMG	ISSUE FOR PHASE 4: PLANNING																															
Client	 Údarás Náisiúnta Iompair National Transport Authority																																			
Engineering Designer	 IROD Infrastructure Road TYPSA																																			
Programme Title	BUSCONNECTS DUBLIN CORE BUS CORRIDORS INFRASTRUCTURE WORKS																																			
Drawing Title	RINGSEND TO CITY CENTRE CORE BUS CORRIDOR SCHEME ESB ASSET ALTERATIONS																																			
Drawing File Name	BCIDD-ROT-UTL_UE-0016_XX_00-DR-CU-0002	Sheet Number	02 of 12																																	
Status	A	Rev	M01																																	
		<table border="1"> <tr> <td>Date</td> <td>MAR 2023</td> <td>Scale</td> <td>1:500 @ A1 1:1000 @ A3</td> <td>Drawn</td> <td>DS</td> <td>Checked</td> <td>EOC</td> <td>Approved</td> <td>SMG</td> </tr> <tr> <td>Programme Code</td> <td>BCIDD</td> <td>Originator Code</td> <td>ROT</td> <td>QMS Code</td> <td></td> <td></td> <td></td> <td></td> <td></td> </tr> </table>	Date	MAR 2023	Scale	1:500 @ A1 1:1000 @ A3	Drawn	DS	Checked	EOC	Approved	SMG	Programme Code	BCIDD	Originator Code	ROT	QMS Code						<p style="text-align: center;">DO NOT SCALE USE FIGURED DIMENSIONS ONLY</p>													
Date	MAR 2023	Scale	1:500 @ A1 1:1000 @ A3	Drawn	DS	Checked	EOC	Approved	SMG																											
Programme Code	BCIDD	Originator Code	ROT	QMS Code																																

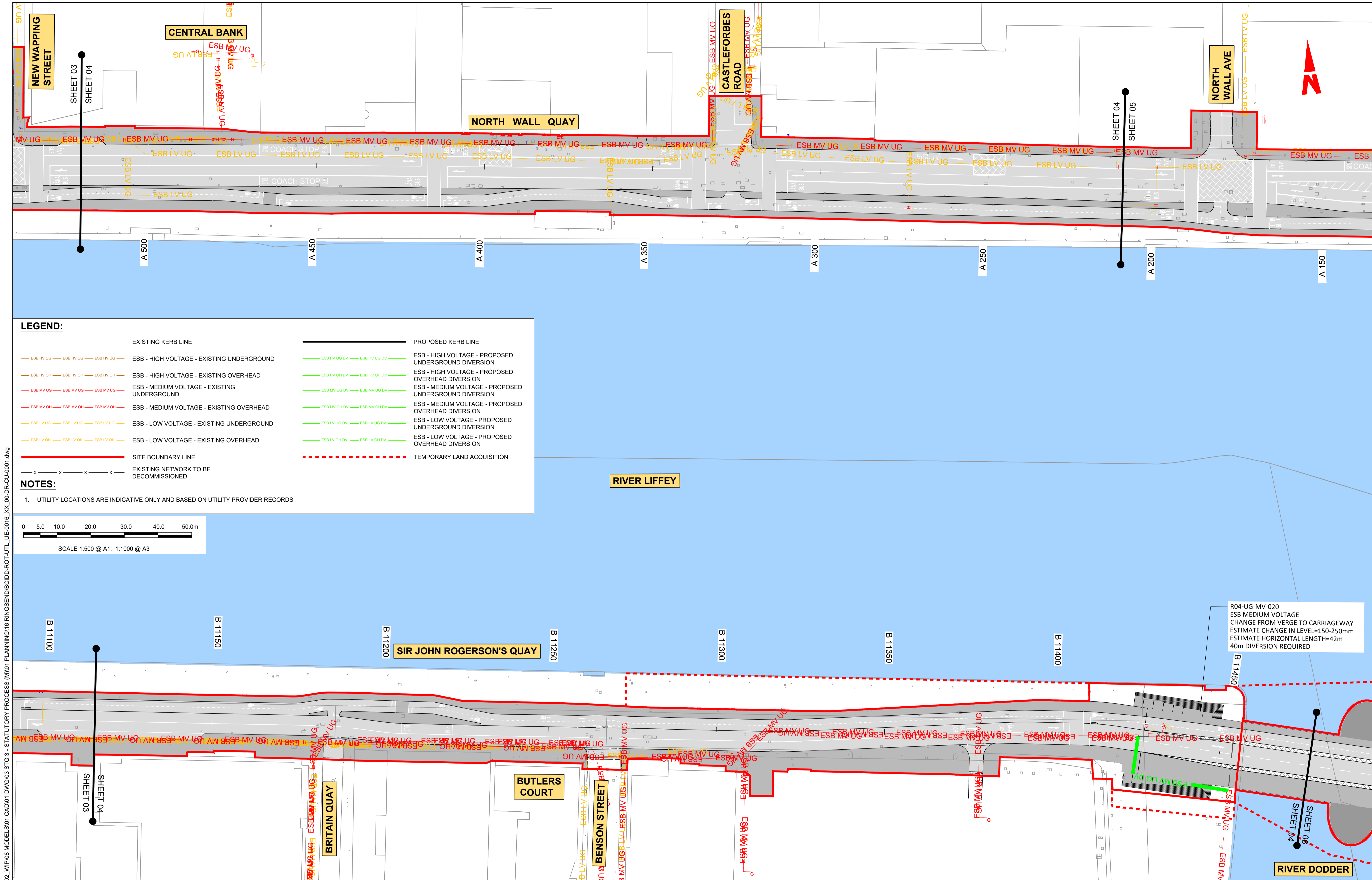

LEGEND:

---	EXISTING KERB LINE	---	PROPOSED KERB LINE
---	ESB - HIGH VOLTAGE - EXISTING UNDERGROUND	---	ESB - HIGH VOLTAGE - PROPOSED UNDERGROUND DIVERSION
---	ESB - HIGH VOLTAGE - EXISTING OVERHEAD	---	ESB - HIGH VOLTAGE - PROPOSED OVERHEAD DIVERSION
---	ESB - MEDIUM VOLTAGE - EXISTING UNDERGROUND	---	ESB - MEDIUM VOLTAGE - PROPOSED UNDERGROUND DIVERSION
---	ESB - MEDIUM VOLTAGE - EXISTING OVERHEAD	---	ESB - MEDIUM VOLTAGE - PROPOSED OVERHEAD DIVERSION
---	ESB - LOW VOLTAGE - EXISTING UNDERGROUND	---	ESB - LOW VOLTAGE - PROPOSED UNDERGROUND DIVERSION
---	ESB - LOW VOLTAGE - EXISTING OVERHEAD	---	ESB - LOW VOLTAGE - PROPOSED OVERHEAD DIVERSION
---	SITE BOUNDARY LINE	---	TEMPORARY LAND ACQUISITION
---	EXISTING NETWORK TO BE DECOMMISSIONED		

NOTES:

- UTILITY LOCATIONS ARE INDICATIVE ONLY AND BASED ON UTILITY PROVIDER RECORDS

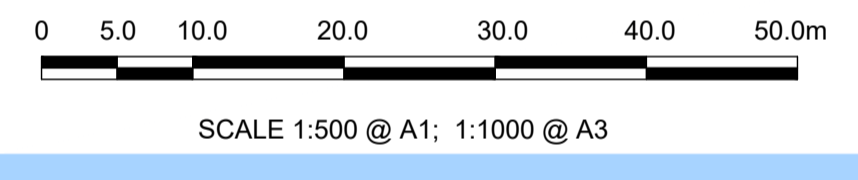

R04-UG-MV-020
ESB MEDIUM VOLTAGE
CHANGE FROM VERGE TO CARRIAGEWAY
ESTIMATE CHANGE IN LEVEL=150-250mm
ESTIMATE HORIZONTAL LENGTH=42m
40m DIVERSION REQUIRED

\\nodubp1u2019171717-02_WIP08 MODELS01 CAD01 DWG03 STG 3 - STATUTORY PROCESS (M)01 PLANNING16 RINGSEND/BCIDD-ROT-UTL_UE-0016_XX_00-DR-CU-0001.dwg

<p>Disclaimer</p> <p>a. © National Transport Authority (NTA) 2022. This drawing is confidential and the copyright in it is owned by NTA. This drawing must not be either loaned, copied or otherwise reproduced in whole or in part or used for any purpose without the prior permission of NTA.</p> <p>b. This drawing is to be used for the design element identified in the titlebox. Other information shown is to be considered indicative only. The drawing is to be read in conjunction with all other relevant design drawings.</p> <p>c. O.S. data used for plans are printed under © Ordnance Survey Ireland Government of Ireland. All rights reserved. Licence Number 2022/OSI_NMA_180 National Transport Authority. All elevations are in metres and relate to OSI Geoid Model (OSGM15) Malin Head. All Co-ordinates are in Irish Transverse Mercator Grid (ITM) as defined by OSI active local GPS station.</p> <p>d. Information concerning the position of apparatus shown on this drawing is based on drawings supplied by the utility owners and/or the utility works contractor, whilst every care has been taken in the preparation of this drawing, positions should be taken as approximate and are intended for general guidance only and no representation is made by the NTA as to the accuracy, completeness, sufficiency or otherwise of this drawing and the position of the apparatus. The information contained herein does not purport to be comprehensive or final as the apparatus is subject to being altered and/or superceded. Recipients should not rely on this information. Any liabilities are hereby expressly disclaimed.</p> <p>e. The information contained herein has been provided by the NTA but does not purport to be comprehensive or final. Recipients should not rely on the information. Neither the NTA nor any of its directors, officers, employees, agents, stakeholders or advisers make any representation or warranty as to, or accept any liability or responsibility in relation to, the adequacy, accuracy, reasonableness or completeness of the information provided as part of this document or any matter on which the information is based (including but not limited to loss or damage arising as a result of reliance by recipients on the information or any part of it). Any liabilities are hereby expressly disclaimed.</p>	<p>Project Ireland 2040 Building Ireland's Future</p>	<table border="1"> <thead> <tr> <th>Rev</th> <th>Date</th> <th>Drn</th> <th>Chk'd</th> <th>App'd</th> <th>Description</th> </tr> </thead> <tbody> <tr> <td>M01</td> <td>MAR 2023</td> <td>DS</td> <td>EOC</td> <td>SMG</td> <td>ISSUE FOR PHASE 4: PLANNING</td> </tr> </tbody> </table>	Rev	Date	Drn	Chk'd	App'd	Description	M01	MAR 2023	DS	EOC	SMG	ISSUE FOR PHASE 4: PLANNING	<p>Client</p> <p>Údarás Náisiúnta Iompair National Transport Authority</p>	<p>Engineering Designer</p> <p>IROD TYPSA</p>	<p>Programme Title</p> <p>BUSCONNECTS DUBLIN CORE BUS CORRIDORS INFRASTRUCTURE WORKS</p>
		Rev	Date	Drn	Chk'd	App'd	Description										
M01	MAR 2023	DS	EOC	SMG	ISSUE FOR PHASE 4: PLANNING												
<p>Date</p> <p>MAR 2023</p> <p>Programme Code</p> <p>BCIDD</p>	<p>Scale</p> <p>1:500 @ A1 1:1000 @ A3</p> <p>Originator Code</p> <p>ROT</p>	<p>Drawn</p> <p>DS</p> <p>Checked</p> <p>EOC</p> <p>Approved</p> <p>SMG</p>	<p>Drawing Title</p> <p>RINGSEND TO CITY CENTRE CORE BUS CORRIDOR SCHEME ESB ASSET ALTERATIONS</p>	<p>Drawing File Name</p> <p>BCIDD-ROT-UTL_UE-0016_XX_00-DR-CU-0004</p>	<p>Sheet Number</p> <p>04 of 12</p>	<p>Status</p> <p>A</p>	<p>Rev</p> <p>M01</p>										

DO NOT SCALE USE FIGURED DIMENSIONS ONLY

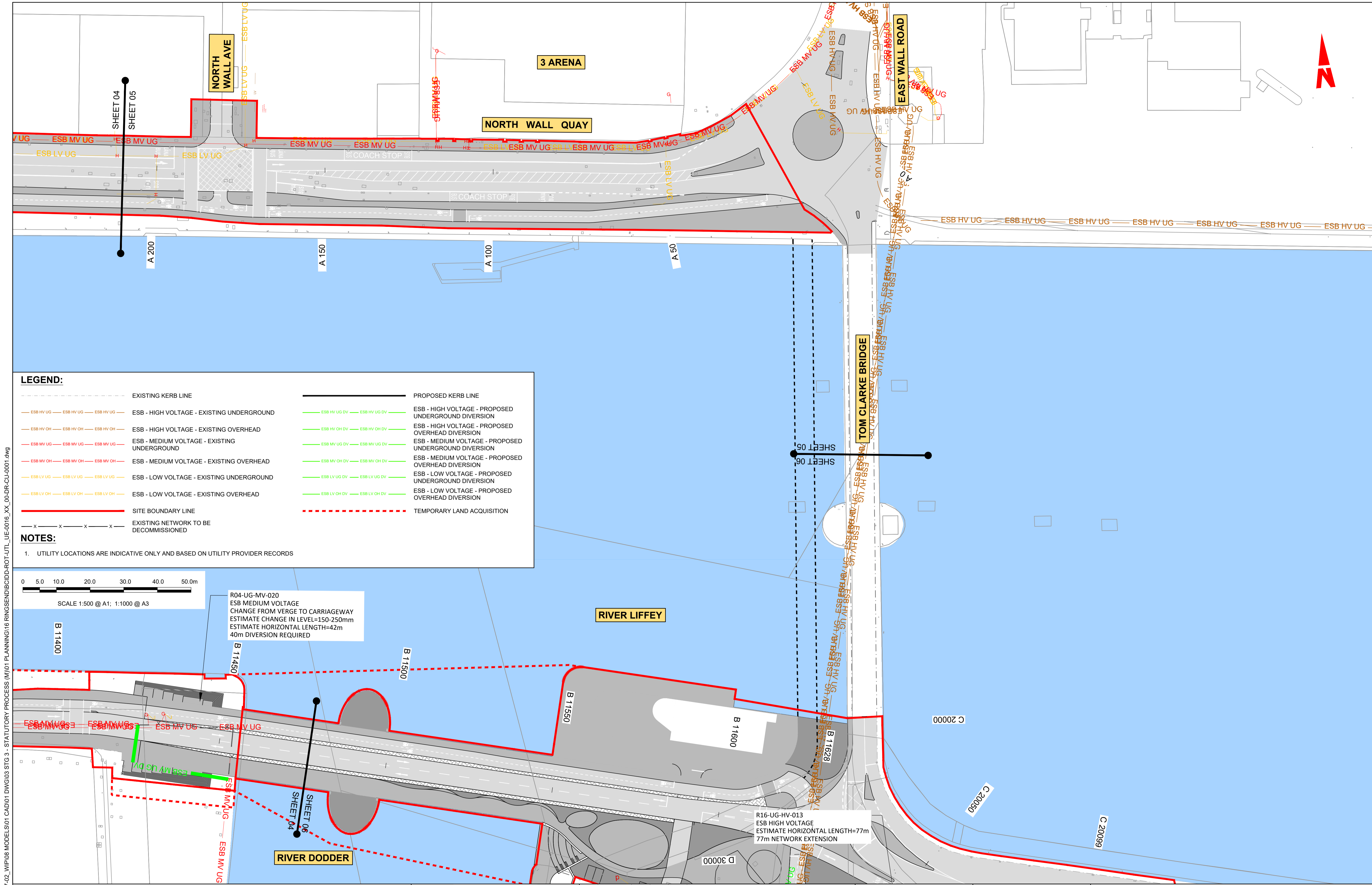

LEGEND:

---	EXISTING KERB LINE	---	PROPOSED KERB LINE
---	ESB HV UG	---	ESB - HIGH VOLTAGE - PROPOSED UNDERGROUND DIVERSION
---	ESB HV OH	---	ESB - HIGH VOLTAGE - PROPOSED OVERHEAD DIVERSION
---	ESB MV UG	---	ESB - MEDIUM VOLTAGE - PROPOSED UNDERGROUND DIVERSION
---	ESB MV OH	---	ESB - MEDIUM VOLTAGE - PROPOSED OVERHEAD DIVERSION
---	ESB LV UG	---	ESB - LOW VOLTAGE - PROPOSED UNDERGROUND DIVERSION
---	ESB LV OH	---	ESB - LOW VOLTAGE - PROPOSED OVERHEAD DIVERSION
---	ESB HV UG	---	ESB - HIGH VOLTAGE - EXISTING UNDERGROUND
---	ESB HV OH	---	ESB - HIGH VOLTAGE - EXISTING OVERHEAD
---	ESB MV UG	---	ESB - MEDIUM VOLTAGE - EXISTING UNDERGROUND
---	ESB MV OH	---	ESB - MEDIUM VOLTAGE - EXISTING OVERHEAD
---	ESB LV UG	---	ESB - LOW VOLTAGE - EXISTING UNDERGROUND
---	ESB LV OH	---	ESB - LOW VOLTAGE - EXISTING OVERHEAD
---	---	---	SITE BOUNDARY LINE
---	---	---	EXISTING NETWORK TO BE DECOMMISSIONED
---	---	---	TEMPORARY LAND ACQUISITION

NOTES:

- UTILITY LOCATIONS ARE INDICATIVE ONLY AND BASED ON UTILITY PROVIDER RECORDS

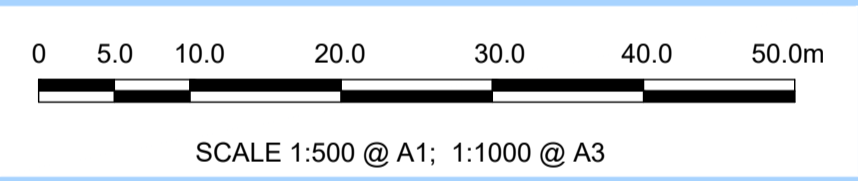

R04-UG-MV-020
ESB MEDIUM VOLTAGE
CHANGE FROM VERGE TO CARRIAGEWAY
ESTIMATE CHANGE IN LEVEL=150-250mm
ESTIMATE HORIZONTAL LENGTH=42m
40m DIVERSION REQUIRED

R16-UG-HV-013
ESB HIGH VOLTAGE
ESTIMATE HORIZONTAL LENGTH=77m
77m NETWORK EXTENSION

Disclaimer:

a. © National Transport Authority (NTA) 2022. This drawing is confidential and the copyright in it is owned by NTA. This drawing must not be either loaned, copied or otherwise reproduced in whole or in part or used for any purpose without the prior permission of NTA.

b. This drawing is to be used for the design element identified in the titleblock. Other information shown is to be considered indicative only. The drawing is to be read in conjunction with all other relevant design drawings.

c. O.S. data used for plans are printed under © Ordnance Survey Ireland Government of Ireland. All rights reserved. Licence Number 2022/OSI_NMA_180 National Transport Authority. All elevations are in metres and relate to OSI Geoid Model (OSGM15) Mean Head. All Co-ordinates are in Irish Transverse Mercator Grid (ITM) as defined by OSI active local GPS station.

d. Information concerning the position of apparatus shown on this drawing is based on drawings supplied by the utility owners and/or the utility works contractor, whilst every care has been taken in the preparation of this drawing, positions should be taken as approximate and are intended for general guidance only and no representation is made by the NTA as to the accuracy, completeness, sufficiency or otherwise of this drawing and the position of the apparatus. The information contained herein does not purport to be comprehensive or final as the apparatus is subject to being altered and/or superceded. Recipients should not rely on this information. Any liabilities are hereby expressly disclaimed.

e. The information contained herein has been provided by the NTA but does not purport to be comprehensive or final. Recipients should not rely on the information. Neither the NTA nor any of its directors, officers, employees, agents, stakeholders or advisers make any representation or warranty as to, or accept any liability or responsibility in relation to, the adequacy, accuracy, reasonableness or completeness of the information provided as part of this document or any matter on which the information is based (including but not limited to loss or damage arising as a result of reliance by recipients on the information or any part of it). Any liabilities are hereby expressly disclaimed.

Rev	Date	Drm	Chk'd	App'd	Description
M01	MAR 2023	DS	EOC	SMG	ISSUE FOR PHASE 4: PLANNING

Client: **NTA**
Udarás Náisiúnta Iompair
National Transport Authority

Engineering Designer: **CIROD**
TYPSA

Date: MAR 2023
Scale: 1:500 @ A1
1:1000 @ A3

Drawn: DS
Checked: EOC
Approved: SMG

Programme Code: BCIDD
Originator Code: ROT
QMS Code:

Programme Title: BUSCONNECTS DUBLIN CORE BUS CORRIDORS INFRASTRUCTURE WORKS			
Drawing Title: RINGSEND TO CITY CENTRE CORE BUS CORRIDOR SCHEME ESB ASSET ALTERATIONS			
Drawing File Name: BCIDD-ROT-UTL_UE-0016_XX_00-DR-CU-0005	Sheet Number: 05 of 12	Status: A	Rev: M01

DO NOT SCALE USE FIGURED DIMENSIONS ONLY

\\nodubhp1\U201919\1719117-02_WIP\08 MODELS\01 CAD\01 DWG\03 STG 3 - STATUTORY PROCESS (M)\01 PLANNING\16 RINGSEND\BCIDD-ROT-UTL_UE-0016_XX_00-DR-CU-0001.dwg



5-MV-020
 MEDIUM VOLTAGE
 FROM VERGE TO CARRIAGEWAY
 STEEP CHANGE IN LEVEL=150-250mm
 STEEP HORIZONTAL LENGTH=42m
 REVISION REQUIRED

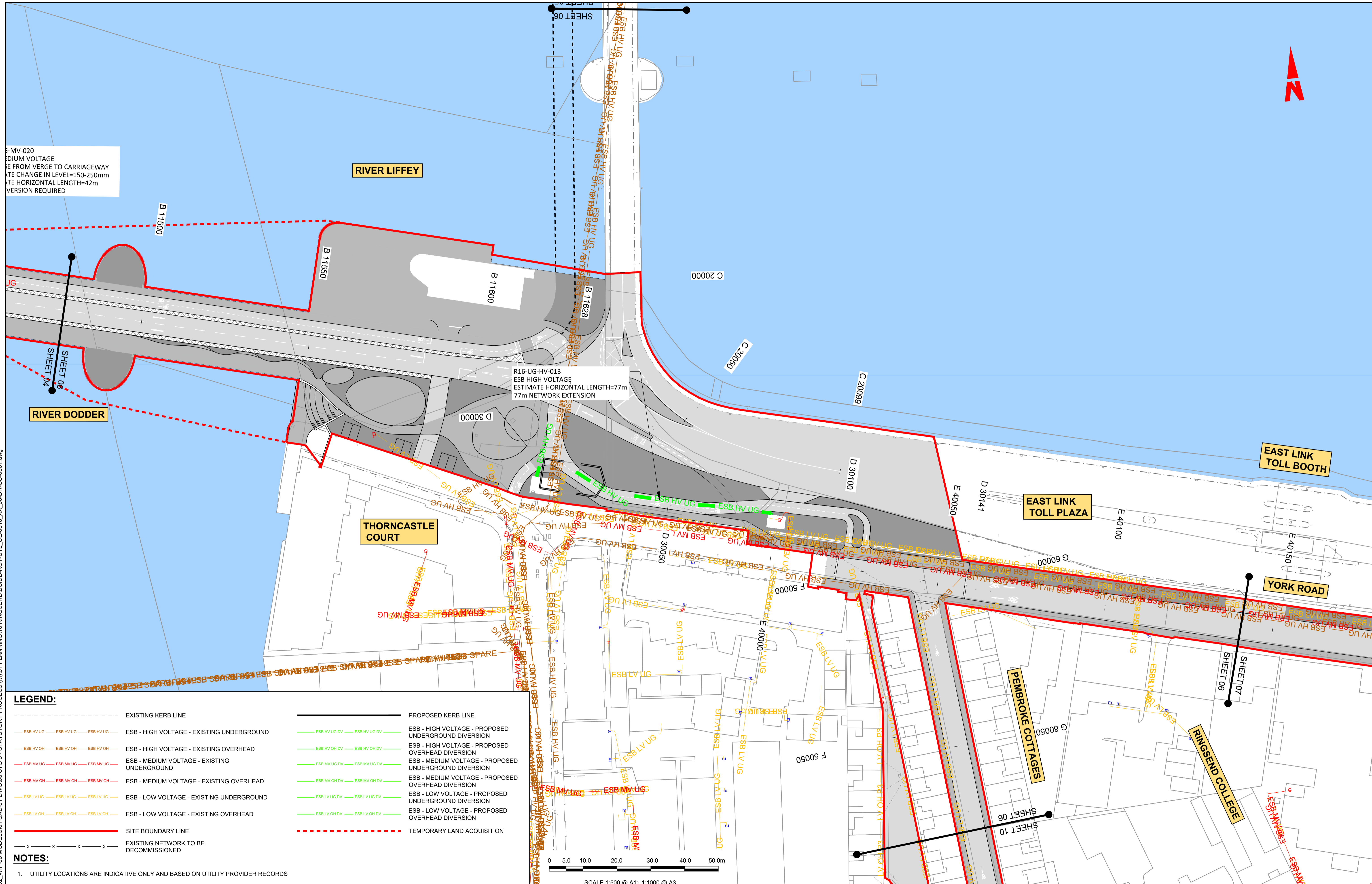

LEGEND:

	EXISTING KERB LINE		PROPOSED KERB LINE
	ESB - HIGH VOLTAGE - EXISTING UNDERGROUND		ESB - HIGH VOLTAGE - PROPOSED UNDERGROUND DIVERSION
	ESB - HIGH VOLTAGE - EXISTING OVERHEAD		ESB - HIGH VOLTAGE - PROPOSED OVERHEAD DIVERSION
	ESB - MEDIUM VOLTAGE - EXISTING UNDERGROUND		ESB - MEDIUM VOLTAGE - PROPOSED UNDERGROUND DIVERSION
	ESB - MEDIUM VOLTAGE - EXISTING OVERHEAD		ESB - MEDIUM VOLTAGE - PROPOSED OVERHEAD DIVERSION
	ESB - LOW VOLTAGE - EXISTING UNDERGROUND		ESB - LOW VOLTAGE - PROPOSED UNDERGROUND DIVERSION
	ESB - LOW VOLTAGE - EXISTING OVERHEAD		ESB - LOW VOLTAGE - PROPOSED OVERHEAD DIVERSION
	SITE BOUNDARY LINE		TEMPORARY LAND ACQUISITION
	EXISTING NETWORK TO BE DECOMMISSIONED		

NOTES:

- UTILITY LOCATIONS ARE INDICATIVE ONLY AND BASED ON UTILITY PROVIDER RECORDS

Disclaimer:

a. © National Transport Authority (NTA) 2022. This drawing is confidential and the copyright in it is owned by NTA. This drawing must not be either loaned, copied or otherwise reproduced in whole or in part or used for any purpose without the prior permission of NTA.

b. This drawing is to be used for the design element identified in the titlebox. Other information shown is to be considered indicative only. The drawing is to be read in conjunction with all other relevant design drawings.

c. O.S. data used for plans are printed under © Ordnance Survey Ireland Government of Ireland. All rights reserved. Licence Number 2022/O.SI_NMA_180 National Transport Authority. All elevations are in metres and relate to OSI Geoid Model (OSGM15) Mean Head. All Co-ordinates are in Irish Transverse Mercator Grid (ITM) as defined by OSI active local GPS station.

d. Information concerning the position of apparatus shown on this drawing is based on drawings supplied by the utility owners and/or the utility works contractor, whilst every care has been taken in the preparation of this drawing, positions should be taken as approximate and are intended for general guidance only and no representation is made by the NTA as to the accuracy, completeness, sufficiency or otherwise of this drawing and the position of the apparatus. The information contained herein does not purport to be comprehensive or final as the apparatus is subject to being altered and/or superceded. Recipients should not rely on this information. Any liabilities are hereby expressly disclaimed.

The information contained herein has been provided by the NTA but does not purport to be comprehensive or final. Recipients should not rely on the information. Neither the NTA nor any of its directors, officers, employees, agents, stakeholders or advisers make any representation or warranty as to, or accept any liability or responsibility in relation to, the adequacy, accuracy, reasonableness or completeness of the information provided as part of this document or any matter on which the information is based (including but not limited to loss or damage arising as a result of reliance by recipients on the information or any part of it). Any liabilities are hereby expressly disclaimed.

Rev	Date	Drm	Chk'd	App'd	Description
M01	MAR 2023	DS	EOC	SMG	ISSUE FOR PHASE 4: PLANNING

Client: **NTA**
 Údarás Náisiúnta Iompair
 National Transport Authority

Engineering Designer: **PROD**
 TYPSA

Date: MAR 2023
 Scale: 1:500 @ A1
 1:1000 @ A3

Drawn: DS
 Checked: EOC
 Approved: SMG

Programme Code: BCIDD
 Originator Code: ROT
 QMS Code:

Programme Title: BUSCONNECTS DUBLIN CORE BUS CORRIDORS INFRASTRUCTURE WORKS			
Drawing Title: RINGSEND TO CITY CENTRE CORE BUS CORRIDOR SCHEME ESB ASSET ALTERATIONS			
Drawing File Name: BCIDD-ROT-UTL_UE-0016_XX_00-DR-CU-0006	Sheet Number: 06 of 12	Status: A	Rev: M01

DO NOT SCALE USE FIGURED DIMENSIONS ONLY

\\produbp1\U201917\17117-02_WIP\08 MODELS\01 CAD\01 DWG\03 STG 3 - STATUTORY PROCESS (M)\01 PLANNING\16 RINGSEND\BCIDD-ROT-UTL_UE-0016_XX_00-DR-CU-0001.dwg

LEGEND:

---	EXISTING KERB LINE	---	PROPOSED KERB LINE
---	ESB - HIGH VOLTAGE - EXISTING UNDERGROUND	---	ESB - HIGH VOLTAGE - PROPOSED UNDERGROUND DIVERSION
---	ESB - HIGH VOLTAGE - EXISTING OVERHEAD	---	ESB - HIGH VOLTAGE - PROPOSED OVERHEAD DIVERSION
---	ESB - MEDIUM VOLTAGE - EXISTING UNDERGROUND	---	ESB - MEDIUM VOLTAGE - PROPOSED UNDERGROUND DIVERSION
---	ESB - MEDIUM VOLTAGE - EXISTING OVERHEAD	---	ESB - MEDIUM VOLTAGE - PROPOSED OVERHEAD DIVERSION
---	ESB - LOW VOLTAGE - EXISTING UNDERGROUND	---	ESB - LOW VOLTAGE - PROPOSED UNDERGROUND DIVERSION
---	ESB - LOW VOLTAGE - EXISTING OVERHEAD	---	ESB - LOW VOLTAGE - PROPOSED OVERHEAD DIVERSION
---	SITE BOUNDARY LINE	---	TEMPORARY LAND ACQUISITION
---	EXISTING NETWORK TO BE DECOMMISSIONED		

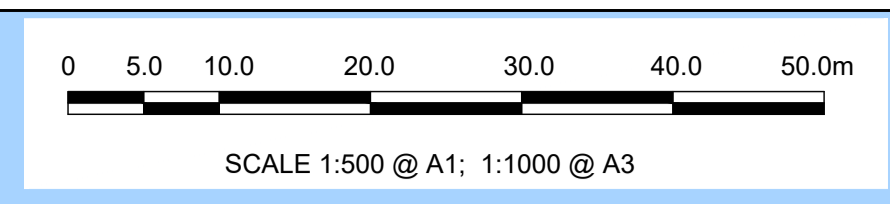

NOTES:

1. UTILITY LOCATIONS ARE INDICATIVE ONLY AND BASED ON UTILITY PROVIDER RECORDS

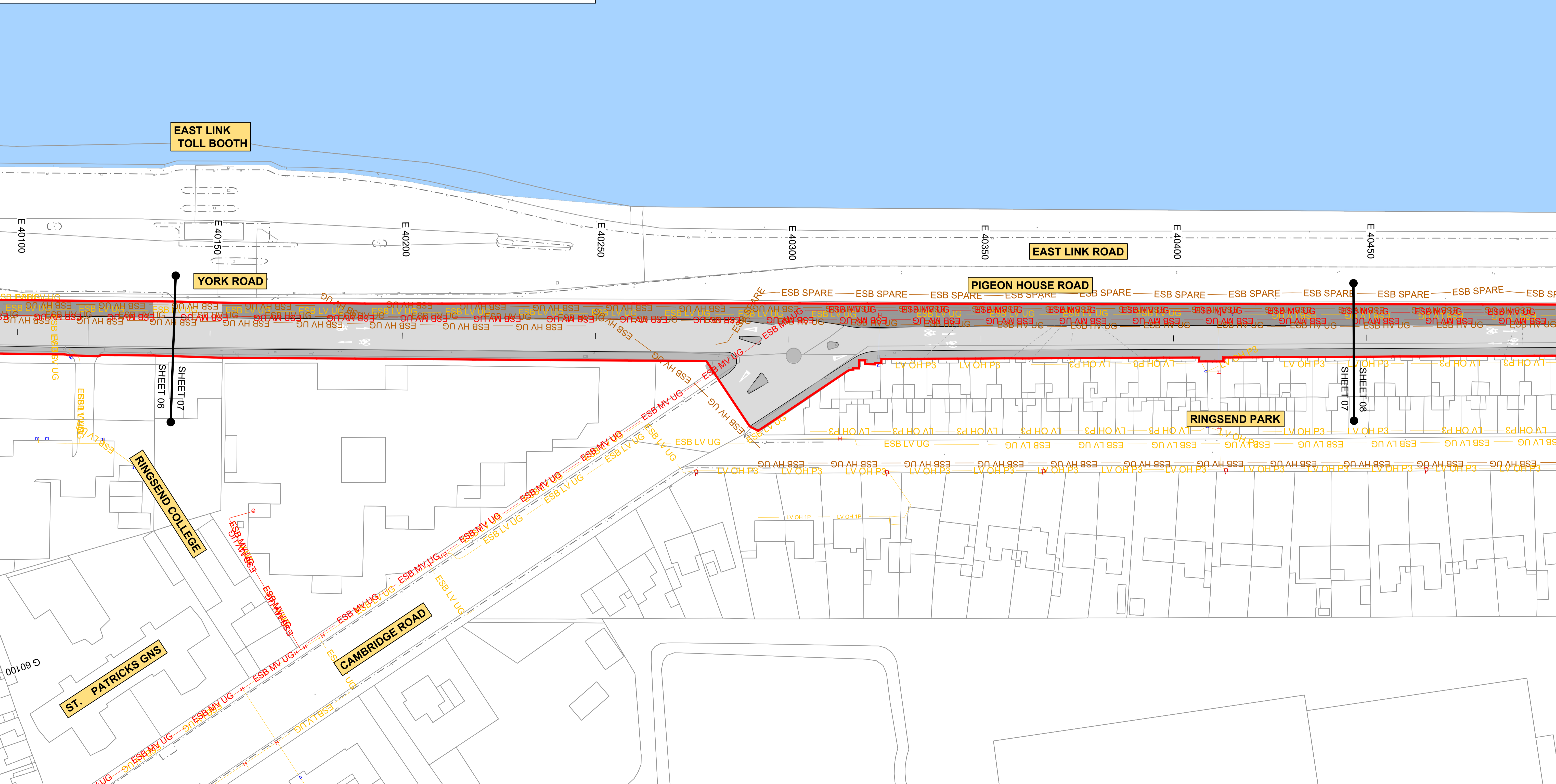

Disclaimer

a. © National Transport Authority (NTA) 2022. This drawing is confidential and the copyright in it is owned by NTA. This drawing must not be either loaned, copied or otherwise reproduced in whole or in part or used for any purpose without the prior permission of NTA.

b. This drawing is to be used for the design element identified in the titleblock. Other information shown is to be considered indicative only. The drawing is to be read in conjunction with all other relevant design drawings.

c. O.S. data used for plans are printed under © Ordnance Survey Ireland Government of Ireland. All rights reserved. Licence Number 2022/OSI_NMA_180 National Transport Authority. All elevations are in metres and relate to OSI Geoid Model (OSGM15) Mean Head. All Co-ordinates are in Irish Transverse Mercator Grid (ITM) as defined by OSI active local GPS station.

d. Information concerning the position of apparatus shown on this drawing is based on drawings supplied by the utility owners and/or the utility works contractor, whilst every care has been taken in the preparation of this drawing, positions should be taken as approximate and are intended for general guidance only and no representation is made by the NTA as to the accuracy, completeness, sufficiency or otherwise of this information. The information contained herein does not purport to be comprehensive or final as the apparatus is subject to being altered and/or superseded. Recipients should not rely on this information. Any liabilities are hereby expressly disclaimed.

e. The information contained herein has been provided by the NTA but does not purport to be comprehensive or final. Recipients should not rely on the information. Neither the NTA nor any of its directors, officers, employees, agents, stakeholders or advisers make any representation or warranty as to, or accept any liability or responsibility in relation to, the adequacy, accuracy, reasonableness or completeness of the information provided as part of this document or any matter on which the information is based (including but not limited to loss or damage arising as a result of reliance by recipients on the information or any part of it). Any liabilities are hereby expressly disclaimed.



Rev	Date	Drn	Chk'd	App'd	Description
M01	MAR 2023	DS	EOC	SMG	ISSUE FOR PHASE 4: PLANNING

Client NTA Udarás Náisiúnta Iompair National Transport Authority		Engineering Designer CIROD TYPSA		
Date MAR 2023	Scale 1:500 @ A1 1:1000 @ A3	Drawn DS	Checked EOC	Approved SMG
Programme Code BCIDD	Originator Code ROT	QMS Code		

Programme Title BUSCONNECTS DUBLIN CORE BUS CORRIDORS INFRASTRUCTURE WORKS			
Drawing Title RINGSEND TO CITY CENTRE CORE BUS CORRIDOR SCHEME ESB ASSET ALTERATIONS			
Drawing File Name BCIDD-ROT-UTL_UE-0016_XX_00-DR-CU-0007	Sheet Number 07 of 12	Status A	Rev M01

DO NOT SCALE USE FIGURED DIMENSIONS ONLY

\\v00dubp1u2019191717117-02_WIP\08 MODELS\01 CAD\01 DWG\03 STG 3 - STATUTORY PROCESS (M)\01 PLANNING\16 RINGSEND\BCIDD-ROT-UTL_UE-0016_XX_00-DR-CU-0001.dwg

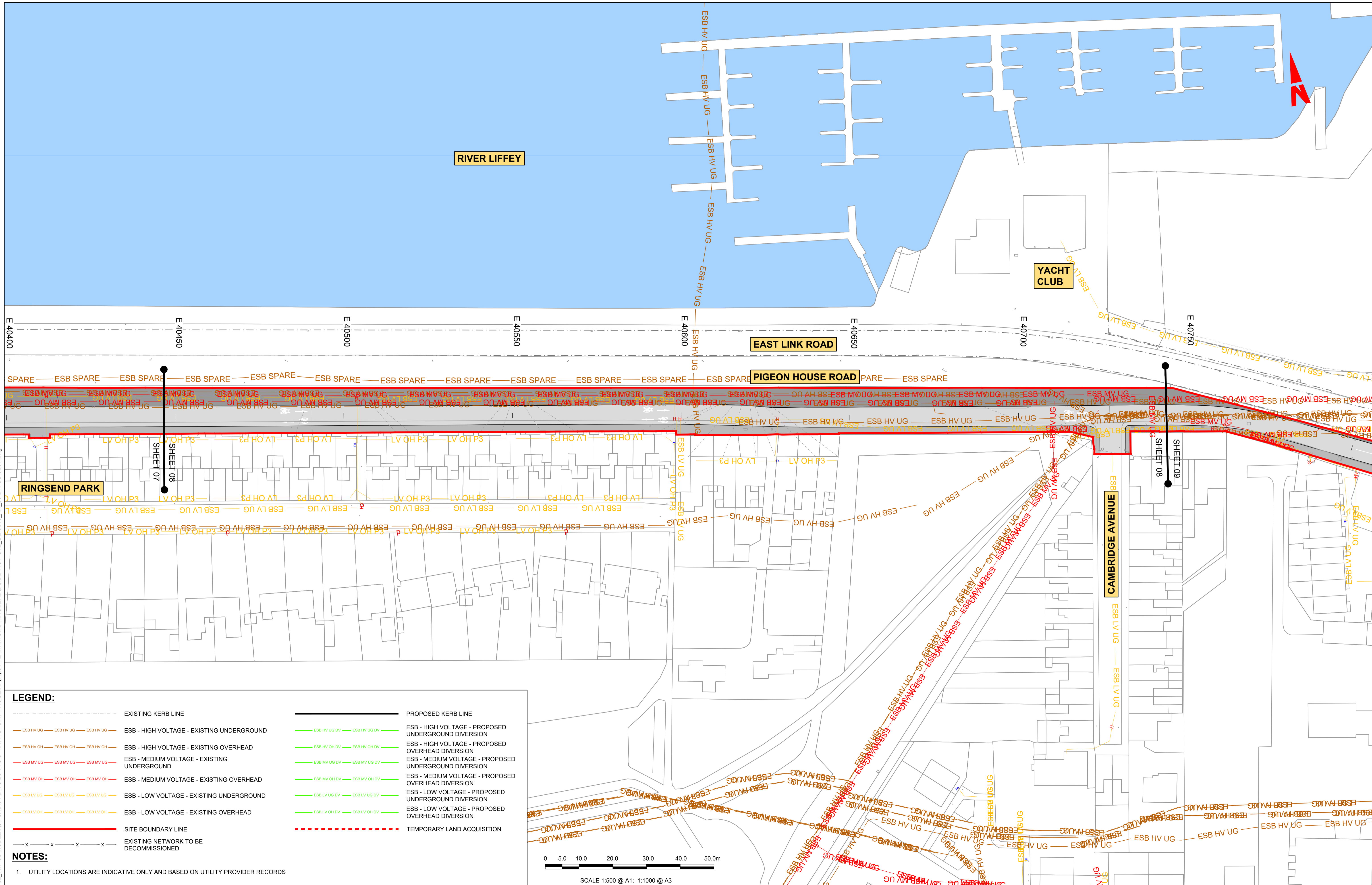

LEGEND:

	EXISTING KERB LINE		PROPOSED KERB LINE
	ESB - HIGH VOLTAGE - EXISTING UNDERGROUND		ESB - HIGH VOLTAGE - PROPOSED UNDERGROUND DIVERSION
	ESB - HIGH VOLTAGE - EXISTING OVERHEAD		ESB - HIGH VOLTAGE - PROPOSED OVERHEAD DIVERSION
	ESB - MEDIUM VOLTAGE - EXISTING UNDERGROUND		ESB - MEDIUM VOLTAGE - PROPOSED UNDERGROUND DIVERSION
	ESB - MEDIUM VOLTAGE - EXISTING OVERHEAD		ESB - MEDIUM VOLTAGE - PROPOSED OVERHEAD DIVERSION
	ESB - LOW VOLTAGE - EXISTING UNDERGROUND		ESB - LOW VOLTAGE - PROPOSED UNDERGROUND DIVERSION
	ESB - LOW VOLTAGE - EXISTING OVERHEAD		ESB - LOW VOLTAGE - PROPOSED OVERHEAD DIVERSION
	SITE BOUNDARY LINE		TEMPORARY LAND ACQUISITION
	EXISTING NETWORK TO BE DECOMMISSIONED		

NOTES:

- UTILITY LOCATIONS ARE INDICATIVE ONLY AND BASED ON UTILITY PROVIDER RECORDS

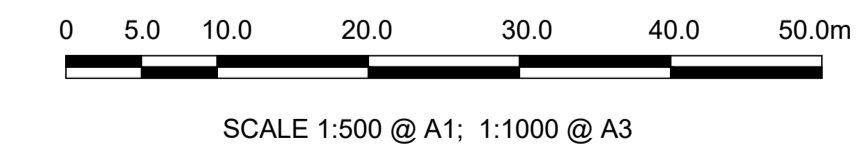

Disclaimer:

a. © National Transport Authority (NTA) 2022. This drawing is confidential and the copyright in it is owned by NTA. This drawing must not be either loaned, copied or otherwise reproduced in whole or in part or used for any purpose without the prior permission of NTA.

b. This drawing is to be used for the design element identified in the titlebox. Other information shown is to be considered indicative only. The drawing is to be read in conjunction with all other relevant design drawings.

c. O.S. data used for plans are printed under © Ordnance Survey Ireland Government of Ireland. All rights reserved. Licence Number 2022/OSI_NMA_180 National Transport Authority. All elevations are in metres and relate to OSI Geoid Model (OSGM15) Mean Head. All Co-ordinates are in Irish Transverse Mercator Grid (ITM) as defined by OSI active local GPS station.

d. Information concerning the position of apparatus shown on this drawing is based on drawings supplied by the utility owners and/or the utility works contractor, whilst every care has been taken in the preparation of this drawing, positions should be taken as approximate and are intended for general guidance only and no representation is made by the NTA as to the accuracy, completeness, sufficiency or otherwise of this drawing and the position of the apparatus. The information contained herein does not purport to be comprehensive or final as the apparatus is subject to being altered and/or superceded. Recipients should not rely on this information. Any liabilities are hereby expressly disclaimed.

e. The information contained herein has been provided by the NTA but does not purport to be comprehensive or final. Recipients should not rely on the information. Neither the NTA nor any of its directors, officers, employees, agents, stakeholders or advisers make any representation or warranty as to, or accept any liability or responsibility in relation to, the adequacy, accuracy, reasonableness or completeness of the information provided as part of this document or any matter on which the information is based (including but not limited to loss or damage arising as a result of reliance by recipients on the information or any part of it). Any liabilities are hereby expressly disclaimed.



Rev	Date	Drm	Chk'd	App'd	Description
M01	MAR 2023	DS	EOC	SMG	ISSUE FOR PHASE 4: PLANNING

Client NTA Udarás Náisiúnta Iompair National Transport Authority		Engineering Designer CIROD TYPSA		
Date MAR 2023	Scale 1:500 @ A1 1:1000 @ A3	Drawn DS	Checked EOC	Approved SMG
Programme Code BCIDD	Originator Code ROT	QMS Code		

Programme Title BUSCONNECTS DUBLIN CORE BUS CORRIDORS INFRASTRUCTURE WORKS				
Drawing Title RINGSEND TO CITY CENTRE CORE BUS CORRIDOR SCHEME ESB ASSET ALTERATIONS				
Drawing File Name BCIDD-ROT-UTL_UE-0016_XX_00-DR-CU-0008	Sheet Number 08 of 12	Status A	Rev M01	

DO NOT SCALE USE FIGURED DIMENSIONS ONLY

\\nodubp1u2019191717117-02_WIP08 MODELS01 CAD01 DWG03 STG 3 - STATUTORY PROCESS (M)01 PLANNING16 RINGSEND/BCIDD-ROT-UTL_UE-0016_XX_00-DR-CU-0001.dwg

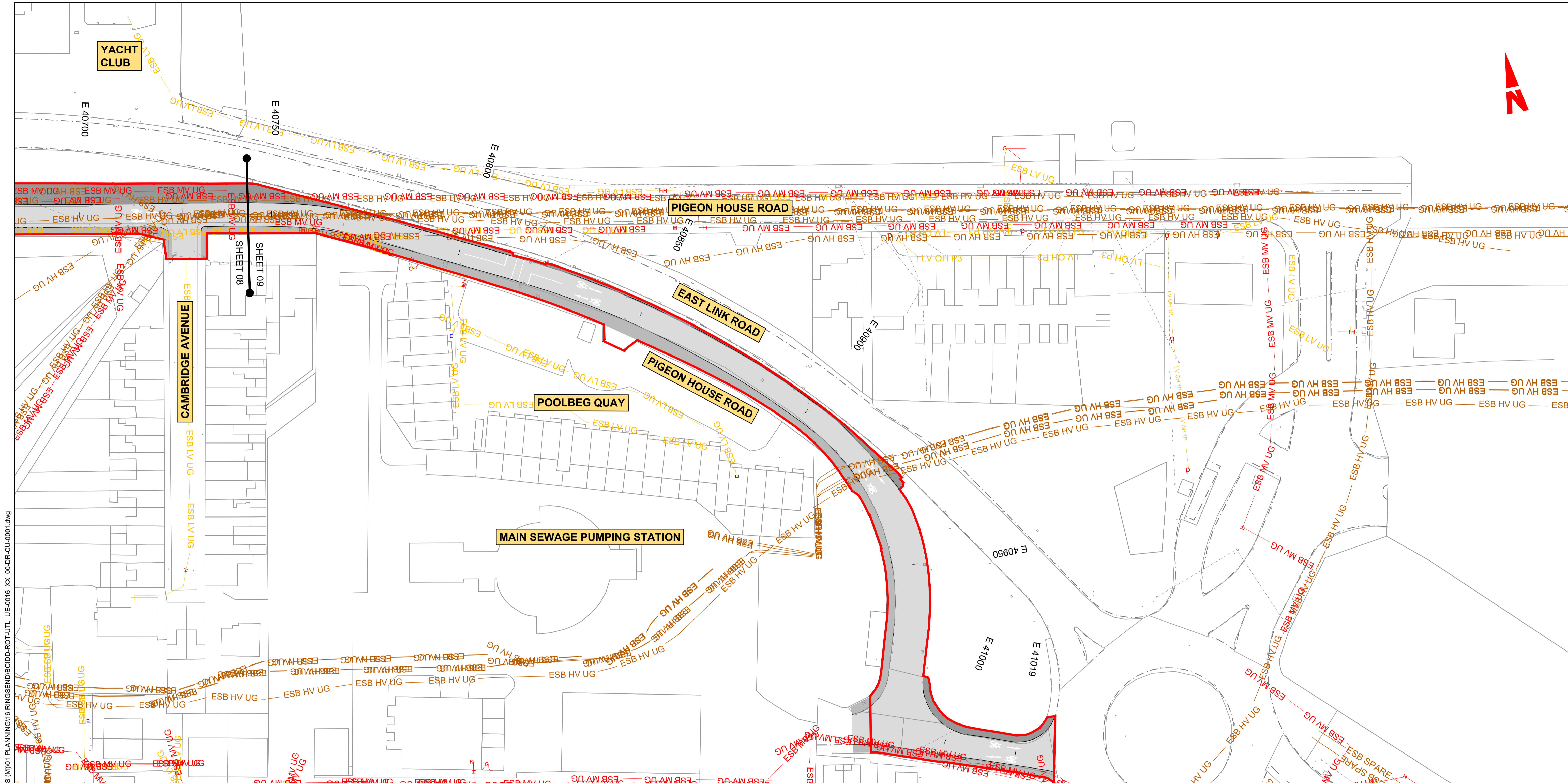

LEGEND:

	EXISTING KERB LINE		PROPOSED KERB LINE
	ESB - HIGH VOLTAGE - EXISTING UNDERGROUND		ESB - HIGH VOLTAGE - PROPOSED UNDERGROUND DIVERSION
	ESB - HIGH VOLTAGE - EXISTING OVERHEAD		ESB - HIGH VOLTAGE - PROPOSED OVERHEAD DIVERSION
	ESB - MEDIUM VOLTAGE - EXISTING UNDERGROUND		ESB - MEDIUM VOLTAGE - PROPOSED UNDERGROUND DIVERSION
	ESB - MEDIUM VOLTAGE - EXISTING OVERHEAD		ESB - MEDIUM VOLTAGE - PROPOSED OVERHEAD DIVERSION
	ESB - LOW VOLTAGE - EXISTING UNDERGROUND		ESB - LOW VOLTAGE - PROPOSED UNDERGROUND DIVERSION
	ESB - LOW VOLTAGE - EXISTING OVERHEAD		ESB - LOW VOLTAGE - PROPOSED OVERHEAD DIVERSION
	SITE BOUNDARY LINE		TEMPORARY LAND ACQUISITION
	EXISTING NETWORK TO BE DECOMMISSIONED		

NOTES:

- UTILITY LOCATIONS ARE INDICATIVE ONLY AND BASED ON UTILITY PROVIDER RECORDS

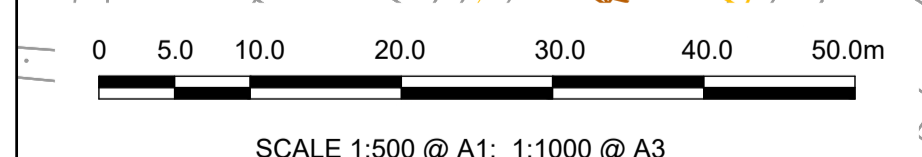

Disclaimer

a. © National Transport Authority (NTA) 2022. This drawing is confidential and the copyright in it is owned by NTA. This drawing must not be either loaned, copied or otherwise reproduced in whole or in part or used for any purpose without the prior permission of NTA.

b. This drawing is to be used for the design element identified in the titlebox. Other information shown is to be considered indicative only. The drawing is to be read in conjunction with all other relevant design drawings.

c. O.S. data used for plans are printed under © Ordnance Survey Ireland Government of Ireland. All rights reserved. Licence Number 2022/OSI_NMA_180 National Transport Authority. All elevations are in metres and relate to OSI Geoid Model (OSGM15) Mean Head. All Co-ordinates are in Irish Transverse Mercator Grid (ITM) as defined by OSI active local GPS station.

d. Information concerning the position of apparatus shown on this drawing is based on drawings supplied by the utility owners and/or the utility works contractor, whilst every care has been taken in the preparation of this drawing, positions should be taken as approximate and are intended for general guidance only and no representation is made by the NTA as to the accuracy, completeness, sufficiency or otherwise of this drawing and the position of the apparatus. The information contained herein does not purport to be comprehensive or final as the apparatus is subject to being altered and/or superceded. Recipients should not rely on this information. Any liabilities are hereby expressly disclaimed.

e. The information contained herein has been provided by the NTA but does not purport to be comprehensive or final. Recipients should not rely on the information. Neither the NTA nor any of its directors, officers, employees, agents, stakeholders or advisers make any representation or warranty as to, or accept any liability or responsibility in relation to, the adequacy, accuracy, reasonableness or completeness of the information provided as part of this document or any matter on which the information is based (including but not limited to loss or damage arising as a result of reliance by recipients on the information or any part of it). Any liabilities are hereby expressly disclaimed.



Rev	Date	Dwn	Chk'd	App'd	Description
M01	MAR 2023	DS	EOC	SMG	ISSUE FOR PHASE 4: PLANNING

Client

Engineering Designer

Date	Scale	Drawn	Checked	Approved
MAR 2023	1:500 @ A1 1:1000 @ A3	DS	EOC	SMG

Programme Title

**BUSCONNECTS DUBLIN
CORE BUS CORRIDORS INFRASTRUCTURE WORKS**

Drawing Title

RINGSEND TO CITY CENTRE CORE BUS CORRIDOR SCHEME
ESB ASSET ALTERATIONS

Drawing File Name	Sheet Number	Status	Rev
BCIDD-ROT-UTL_UE-0016_XX_00-DR-CU-0009	09 of 12	A	M01

DO NOT SCALE USE FIGURED DIMENSIONS ONLY

\\v004bhp1u201919171719117-02_WIP08 MODELS01 CAD01 DWG003 STG 3 - STATUTORY PROCESS (M)01 PLANNING16 RINGSEND-ROT-UTL_UE-0016_XX_00-DR-CU-0001.dwg

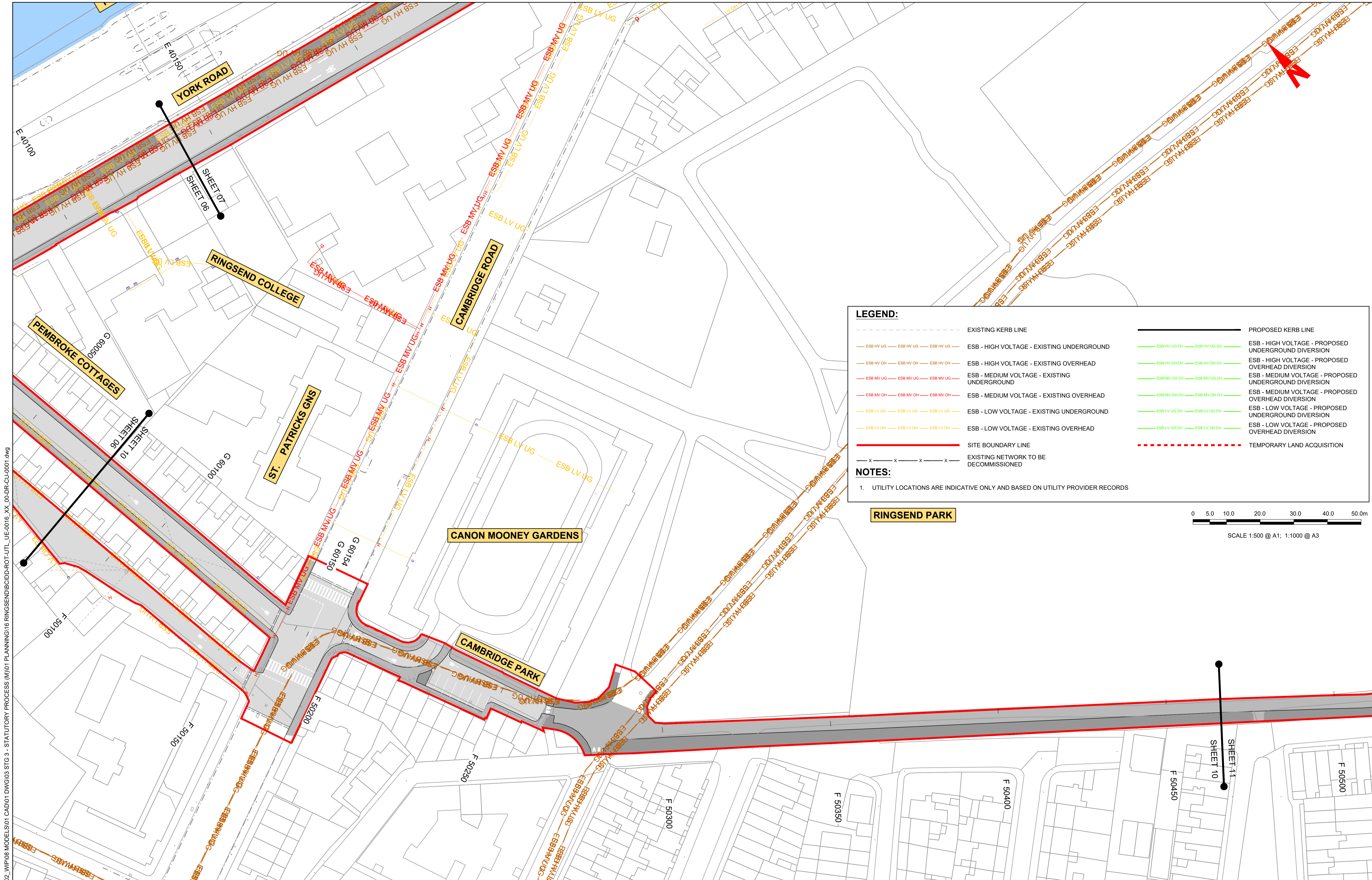

LEGEND:

	EXISTING KERB LINE		PROPOSED KERB LINE		
	ESB HV UG	ESB - HIGH VOLTAGE - EXISTING UNDERGROUND		ESB HV UG DV	ESB - HIGH VOLTAGE - PROPOSED UNDERGROUND DIVERSION
	ESB HV OH	ESB - HIGH VOLTAGE - EXISTING OVERHEAD		ESB HV OH DV	ESB - HIGH VOLTAGE - PROPOSED OVERHEAD DIVERSION
	ESB MV UG	ESB - MEDIUM VOLTAGE - EXISTING UNDERGROUND		ESB MV UG DV	ESB - MEDIUM VOLTAGE - PROPOSED UNDERGROUND DIVERSION
	ESB MV OH	ESB - MEDIUM VOLTAGE - EXISTING OVERHEAD		ESB MV OH DV	ESB - MEDIUM VOLTAGE - PROPOSED OVERHEAD DIVERSION
	ESB LV UG	ESB - LOW VOLTAGE - EXISTING UNDERGROUND		ESB LV UG DV	ESB - LOW VOLTAGE - PROPOSED UNDERGROUND DIVERSION
	ESB LV OH	ESB - LOW VOLTAGE - EXISTING OVERHEAD		ESB LV OH DV	ESB - LOW VOLTAGE - PROPOSED OVERHEAD DIVERSION
	SITE BOUNDARY LINE			TEMPORARY LAND ACQUISITION	
	EXISTING NETWORK TO BE DECOMMISSIONED				

NOTES:

- UTILITY LOCATIONS ARE INDICATIVE ONLY AND BASED ON UTILITY PROVIDER RECORDS

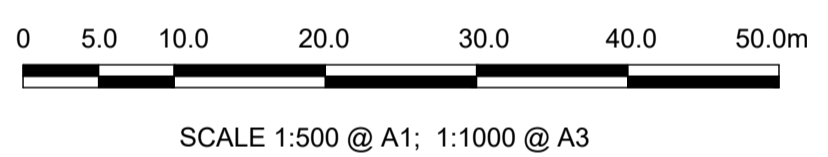

\\v00dubp1u20191917119117-02_WIP08 MODELS01 CAD01 DWG003 STG 3 - STATUTORY PROCESS (M)01 PLANNING16 RINGSEND\BCIDD-ROT-UTL_UE-0016_XX_00-DR-CU-0001.dwg

Disclaimer
 a. © National Transport Authority (NTA) 2022. This drawing is confidential and the copyright in it is owned by NTA. This drawing must not be either loaned, copied or otherwise reproduced in whole or in part or used for any purpose without the prior permission of NTA.
 b. This drawing is to be used for the design element identified in the titleblock. Other information shown is to be considered indicative only. The drawing is to be read in conjunction with all other relevant design drawings.
 c. O.S. data used for plans are printed under © Ordnance Survey Ireland Government of Ireland. All rights reserved. Licence Number 2022/OSI_NMA_180 National Transport Authority. All elevations are in metres and relate to OSI Geoid Model (OSGM15) Mean Head. All Co-ordinates are in Irish

Transverse Mercator Grid (ITM) as defined by OSI active local GPS station.
 d. Information concerning the position of apparatus shown on this drawing is based on drawings supplied by the utility owners and/or the utility works contractor, whilst every care has been taken in the preparation of this drawing, positions should be taken as approximate and are intended for general guidance only and no representation is made by the NTA as to the accuracy, completeness, sufficiency or otherwise of this drawing and the position of the apparatus. The information contained herein does not purport to be comprehensive or final as the apparatus is subject to being altered and/or superceded. Recipients should not rely on this information. Any liabilities are hereby expressly disclaimed.

The information contained herein has been provided by the NTA but does not purport to be comprehensive or final. Recipients should not rely on the information. Neither the NTA nor any of its directors, officers, employees, agents, stakeholders or advisers make any representation or warranty as to, or accept any liability or responsibility in relation to, the adequacy, accuracy, reasonableness or completeness of the information provided as part of this document or any matter on which the information is based (including but not limited to loss or damage arising as a result of reliance by recipients on the information or any part of it). Any liabilities are hereby expressly disclaimed.



Rev	Date	Drn	Chk'd	App'd	Description
M01	MAR 2023	DS	EOC	SMG	ISSUE FOR PHASE 4: PLANNING

Client

 Údarás Náisiúnta Iompair
 National Transport Authority

Engineering Designer

 CIROD
 TYPSA

Programme Title
BUSCONNECTS DUBLIN
CORE BUS CORRIDORS INFRASTRUCTURE WORKS

Drawing Title
 RINGSEND TO CITY CENTRE CORE BUS CORRIDOR SCHEME
 ESB ASSET ALTERATIONS

Date
 MAR 2023

Scale
 1:500 @ A1
 1:1000 @ A3

Drawn
 DS

Checked
 EOC

Approved
 SMG

Programme Code
 BCIDD

Originator Code
 ROT

QMS Code

Drawing File Name
 BCIDD-ROT-UTL_UE-0016_XX_00-DR-CU-0010

Sheet Number
 10 of 12

Status
 A

Rev
 M01

DO NOT SCALE USE FIGURED DIMENSIONS ONLY

LEGEND:

	EXISTING KERB LINE		PROPOSED KERB LINE
	ESB - HIGH VOLTAGE - EXISTING UNDERGROUND		ESB - HIGH VOLTAGE - PROPOSED UNDERGROUND DIVERSION
	ESB - HIGH VOLTAGE - EXISTING OVERHEAD		ESB - HIGH VOLTAGE - PROPOSED OVERHEAD DIVERSION
	ESB - MEDIUM VOLTAGE - EXISTING UNDERGROUND		ESB - MEDIUM VOLTAGE - PROPOSED UNDERGROUND DIVERSION
	ESB - MEDIUM VOLTAGE - EXISTING OVERHEAD		ESB - MEDIUM VOLTAGE - PROPOSED OVERHEAD DIVERSION
	ESB - LOW VOLTAGE - EXISTING UNDERGROUND		ESB - LOW VOLTAGE - PROPOSED UNDERGROUND DIVERSION
	ESB - LOW VOLTAGE - EXISTING OVERHEAD		ESB - LOW VOLTAGE - PROPOSED OVERHEAD DIVERSION
	SITE BOUNDARY LINE		TEMPORARY LAND ACQUISITION
	EXISTING NETWORK TO BE DECOMMISSIONED		

NOTES:

- UTILITY LOCATIONS ARE INDICATIVE ONLY AND BASED ON UTILITY PROVIDER RECORDS

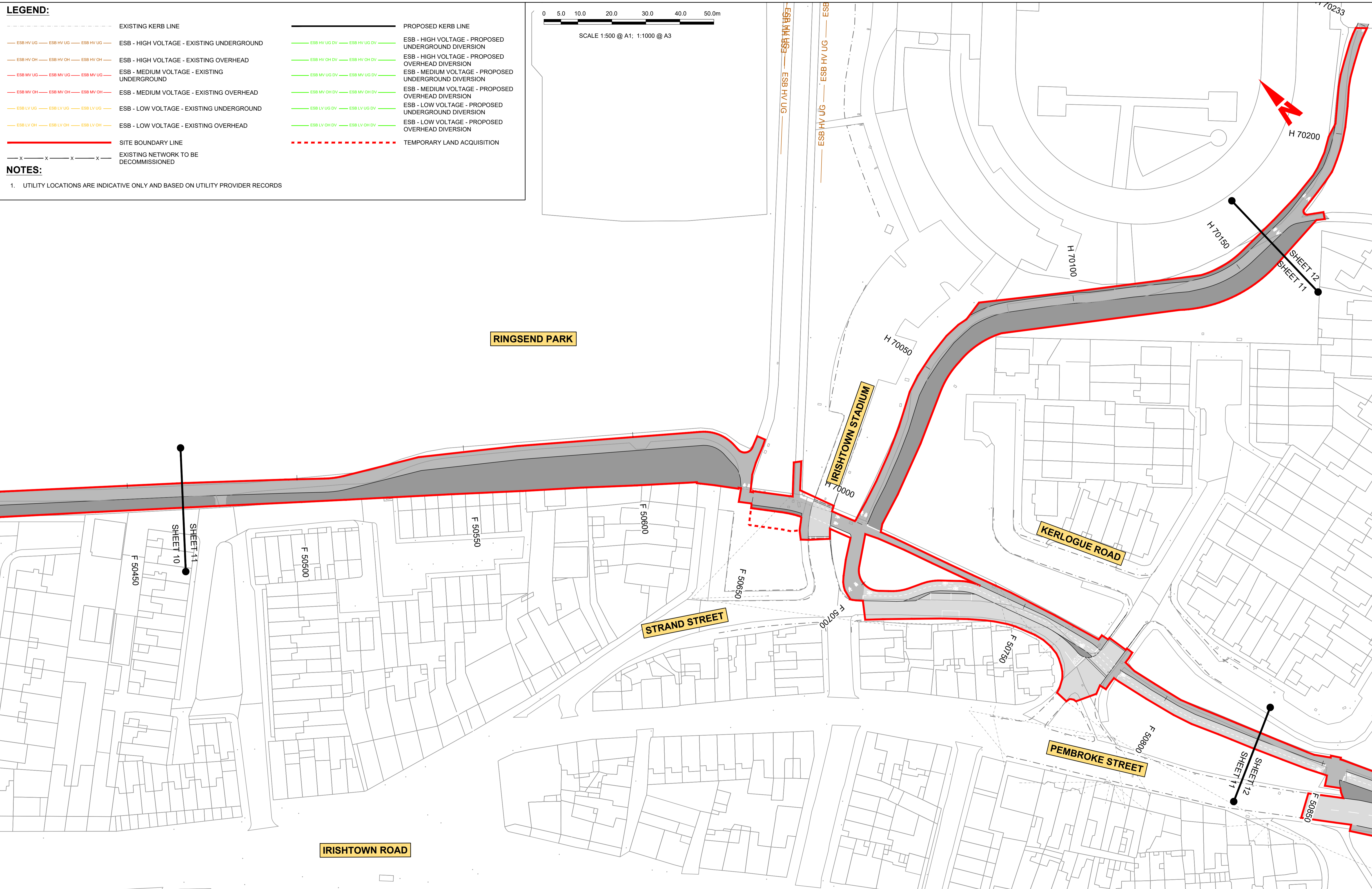
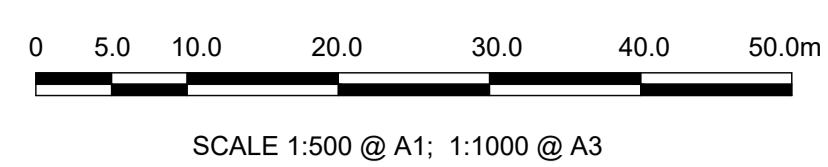

\\vodubp1u20191917119117-02_WIP08 MODELS01 CAD01 DWG03 STG 3 - STATUTORY PROCESS (M)01 PLANNING16 RINGSEND\BCIDD-ROT-UTL_UE-0016_XX_00-DR-CU-0001.dwg

Disclaimer

a. © National Transport Authority (NTA) 2022. This drawing is confidential and the copyright in it is owned by NTA. This drawing must not be either loaned, copied or otherwise reproduced in whole or in part or used for any purpose without the prior permission of NTA.

b. This drawing is to be used for the design element identified in the titlebox. Other information shown is to be considered indicative only. The drawing is to be read in conjunction with all other relevant design drawings.

c. O.S. data used for plans are printed under © Ordnance Survey Ireland Government of Ireland. All rights reserved. Licence Number 2022/OSI_NMA_180 National Transport Authority. All elevations are in metres and relate to OSI Geoid Model (OSGM15) Mean Head. All Co-ordinates are in Irish Transverse Mercator Grid (ITM) as defined by OSI active local GPS station.

d. Information concerning the position of apparatus shown on this drawing is based on drawings supplied by the utility owners and/or the utility works contractor, whilst every care has been taken in the preparation of this drawing, positions should be taken as approximate and are intended for general guidance only and no representation is made by the NTA as to the accuracy, completeness, sufficiency or otherwise of this drawing and the position of the apparatus. The information contained herein does not purport to be comprehensive or final as the apparatus is subject to being altered and/or superseded. Recipients should not rely on this information. Any liabilities are hereby expressly disclaimed.

e. The information contained herein has been provided by the NTA but does not purport to be comprehensive or final. Recipients should not rely on the information. Neither the NTA nor any of its directors, officers, employees, agents, stakeholders or advisers make any representation or warranty as to, or accept any liability or responsibility in relation to, the adequacy, accuracy, reasonableness or completeness of the information provided as part of this document or any matter on which the information is based (including but not limited to loss or damage arising as a result of reliance by recipients on the information or any part of it). Any liabilities are hereby expressly disclaimed.



Rev	Date	Drn	Chk'd	App'd	Description
M01	MAR 2023	DS	EOC	SMG	ISSUE FOR PHASE 4: PLANNING

 Údarás Náisiúnta Iompair National Transport Authority		Engineering Designer IROD TYPSA		
Date	Scale	Drawn	Checked	Approved
MAR 2023	1:500 @ A1 1:1000 @ A3	DS	EOC	SMG
Programme Code	Originator Code	QMS Code		
BCIDD	ROT			

Programme Title BUSCONNECTS DUBLIN CORE BUS CORRIDORS INFRASTRUCTURE WORKS			
Drawing Title RINGSEND TO CITY CENTRE CORE BUS CORRIDOR SCHEME ESB ASSET ALTERATIONS			
Drawing File Name	Sheet Number	Status	Rev
BCIDD-ROT-UTL_UE-0016_XX_00-DR-CU-0011	11 of 12	A	M01

DO NOT SCALE USE FIGURED DIMENSIONS ONLY

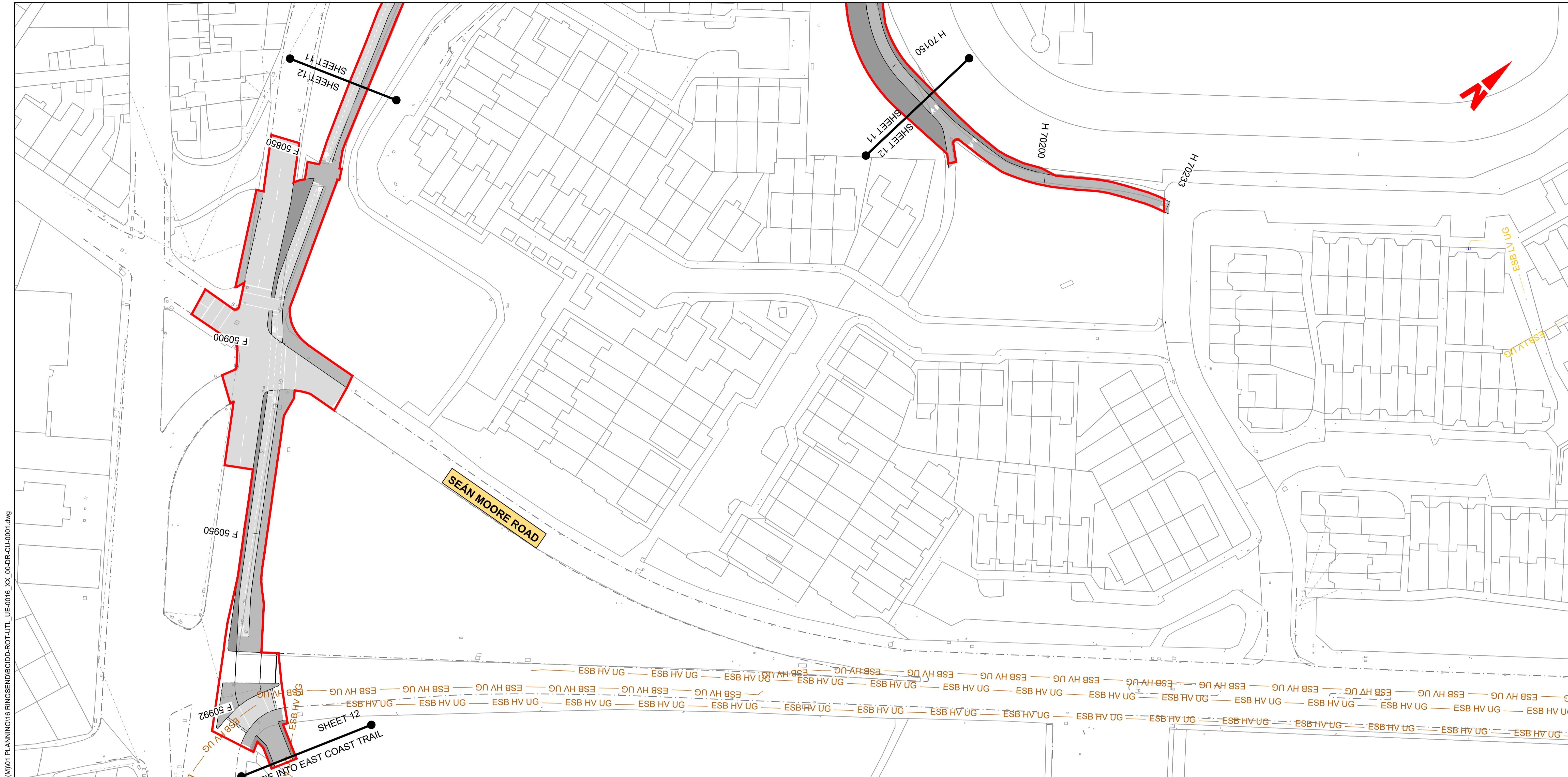

\\nodubp1u20191917117-02_WIP08 MODELS01 CAD01 DWG003 STG 3 - STATUTORY PROCESS (M)01 PLANNING16 RINGSEND/BCIDD-ROT-UTL_UE-0016_XX_00-DR-CU-0001.dwg

LEGEND:

	EXISTING KERB LINE		PROPOSED KERB LINE
	ESB - HIGH VOLTAGE - EXISTING UNDERGROUND		ESB - HIGH VOLTAGE - PROPOSED UNDERGROUND DIVERSION
	ESB - HIGH VOLTAGE - EXISTING OVERHEAD		ESB - HIGH VOLTAGE - PROPOSED OVERHEAD DIVERSION
	ESB - MEDIUM VOLTAGE - EXISTING UNDERGROUND		ESB - MEDIUM VOLTAGE - PROPOSED UNDERGROUND DIVERSION
	ESB - MEDIUM VOLTAGE - EXISTING OVERHEAD		ESB - MEDIUM VOLTAGE - PROPOSED OVERHEAD DIVERSION
	ESB - LOW VOLTAGE - EXISTING UNDERGROUND		ESB - LOW VOLTAGE - PROPOSED UNDERGROUND DIVERSION
	ESB - LOW VOLTAGE - EXISTING OVERHEAD		ESB - LOW VOLTAGE - PROPOSED OVERHEAD DIVERSION
	SITE BOUNDARY LINE		TEMPORARY LAND ACQUISITION
	EXISTING NETWORK TO BE DECOMMISSIONED		

NOTES:

- UTILITY LOCATIONS ARE INDICATIVE ONLY AND BASED ON UTILITY PROVIDER RECORDS

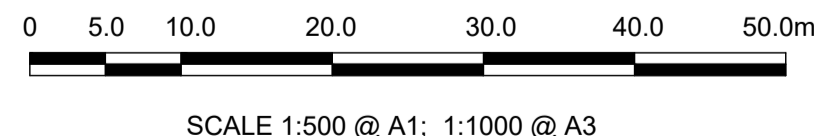

Disclaimer

a. © National Transport Authority (NTA) 2022. This drawing is confidential and the copyright in it is owned by NTA. This drawing must not be either loaned, copied or otherwise reproduced in whole or in part or used for any purpose without the prior permission of NTA.

b. This drawing is to be used for the design element identified in the titleblock. Other information shown is to be considered indicative only. The drawing is to be read in conjunction with all other relevant design drawings.

c. D.S. data used for plans are printed under © Ordnance Survey Ireland Government of Ireland. All rights reserved. Licence Number 2022/OSI_NMA_180 National Transport Authority. All elevations are in metres and relate to OSI Geoid Model (OSGM15) Mean Head. All Co-ordinates are in Irish Transverse Mercator Grid (ITM) as defined by OSI active local GPS station.

d. Information concerning the position of apparatus shown on this drawing is based on drawings supplied by the utility owners and/or the utility works contractor, whilst every care has been taken in the preparation of this drawing, positions should be taken as approximate and are intended for general guidance only and no representation is made by the NTA as to the accuracy, completeness, sufficiency or otherwise of this drawing and the position of the apparatus. The information contained herein does not purport to be comprehensive or final as the apparatus is subject to being altered and/or superseded. Recipients should not rely on this information. Any liabilities are hereby expressly disclaimed.

e. The information contained herein has been provided by the NTA but does not purport to be comprehensive or final. Recipients should not rely on the information. Neither the NTA nor any of its directors, officers, employees, agents, stakeholders or advisers make any representation or warranty as to, or accept any liability or responsibility in relation to, the adequacy, accuracy, reasonableness or completeness of the information provided as part of this document or any matter on which the information is based (including but not limited to loss or damage arising as a result of reliance by recipients on the information or any part of it). Any liabilities are hereby expressly disclaimed.



Rev	Date	Drn	Chk'd	App'd	Description
M01	MAR 2023	DS	EOC	SMG	ISSUE FOR PHASE 4: PLANNING

Client: **NTA**
Údarás Náisiúnta Iompair
National Transport Authority

Engineering Designer: **CIROD**
TYPSA

Date: MAR 2023 | Scale: 1:500 @ A1, 1:1000 @ A3 | Drawn: DS | Checked: EOC | Approved: SMG

Programme Code: BCIDD | Originator Code: ROT | QMS Code:

Programme Title: BUSCONNECTS DUBLIN CORE BUS CORRIDORS INFRASTRUCTURE WORKS			
Drawing Title: RINGSEND TO CITY CENTRE CORE BUS CORRIDOR SCHEME ESB ASSET ALTERATIONS			
Drawing File Name: BCIDD-ROT-UTL_UE-0016_XX_00-DR-CU-0012	Sheet Number: 12 of 12	Status: A	Rev: M01

DO NOT SCALE USE FIGURED DIMENSIONS ONLY